

EN

TECHNICAL  
MANUAL

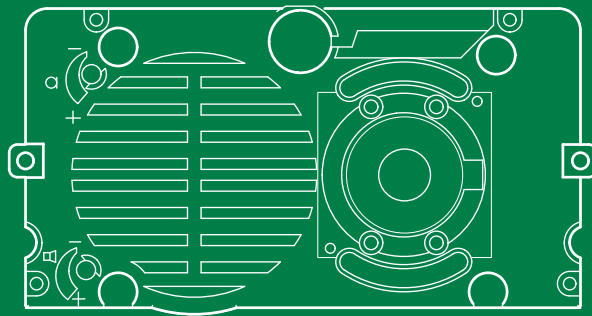

Audio/video module for ViP system  
Art. 4682HD

 **Comelit**<sup>®</sup>  
Passion. Technology. Design.

# Warning

## Intended use

This Comelit product has been designed and manufactured for use in the creation of audio and video communication systems in residential, commercial, industrial and public buildings.

## Installation

All activities connected to the installation of Comelit products must be carried out by qualified technical personnel, with careful observation of the indications provided in the Manuals / Instruction sheets supplied with those products.

## Wires

Disconnect the power supply before carrying out any operations on the wiring.

Use wires with a cross-section suited to the distances involved, observing the instructions provided in the system manual.

We advise against running the system wires through the same duct as power cables (230V or higher).

## Safe usage

To ensure Comelit products are used safely:

- carefully observe the indications provided in the Manuals / Instruction sheets,
- make sure the system created using Comelit products has not been tampered with / damaged.

## Maintenance

Comelit products do not require maintenance aside from routine cleaning, which should be carried out in accordance with the indications provided in the Manuals / Instruction sheets.

Any repairs must be carried out:

- for the products themselves, exclusively by **Comelit Group S.p.A.**,
- for the systems, by qualified technical personnel.

## Disclaimer

**Comelit Group S.p.A.** accepts no liability for

- any purpose other than the intended use,
- failure to observe the indications and warnings contained in this Manual / Instruction sheet.

**Comelit Group S.p.A.** reserves the right to change the information provided in this Manual / Instruction sheet at any time and without prior notice.







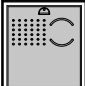
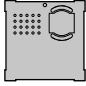
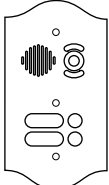

# Table of contents

<b>Warning</b> .....	<b>2</b>	<b>Modules for Single-plate external unit</b> .....	<b>12</b>
<b>Description</b> .....	<b>3</b>	Connection of Art. 3063D with additional power supply .....	12
Art. 4682HD - Compatibility table.....	3	<b>Simplekey modules</b> .....	<b>13</b>
<b>Technical characteristics</b> .....	<b>5</b>	Connection of readers Art. SK9000I, Art. SK9001I.....	13
<b>External unit installation</b> .....	<b>6</b>	<b>Programming</b> .....	<b>14</b>
<b>Connections</b> .....	<b>7</b>	Assigning an index number to the “additional button modules” .....	14
Connection with POE power supply.....	7	Addressing table .....	15
Connection with additional power supply (Art. 1595) .....	7	Device reset.....	16
Variants .....	8	<b>Connection distances</b> .....	<b>17</b>
<b>Module Connection</b> .....	<b>9</b>		
External unit module consumption table.....	9		
<b>Connection of Ikall modules</b> .....	<b>10</b>		
Connection of button modules 33433, 33434, 33436, 33433M, 33434M, 33436M.....	10		
Connection of Art. 3360B, 3360BM.....	10		
<b>Connection of Vandalcom modules</b> .....	<b>11</b>		
Connection of Art. 3064S and Art. 1172B .....	11		
Connection of Art. 3188SB.....	11		
Connection of Art. 3070S, 3072S.....	12		

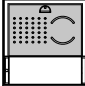
# Description

The **4682HD** colour audio-video module is compatible with ViP door entry monitor systems.

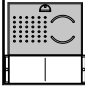
It can be installed in *Icall*, *Icall Metal*, *Vandalcom* and *Roma* series external units and can be finished with additional modules to meet all system requirements.

Art. 4682HD - Compatibility table				
<i>Icall</i>		<i>Icall Metal</i>	<i>Vandalcom</i> *	<i>Roma</i>
 33410		 33410M	 3268S/0	 32xx/RI
 33411	 33411A	 33411M	 3268S/1	
 33412	 33412A	 33412M	 3268S/2	

 For programming and configuration of the external unit and system parameters use the *ViP Manager* software, which can be downloaded from [pro.comelitgroup.com](http://pro.comelitgroup.com).

\* For Vandalcom audio/video modules, select the configuration “**Video adaptation: Vandalcom**” in ViP Manager.

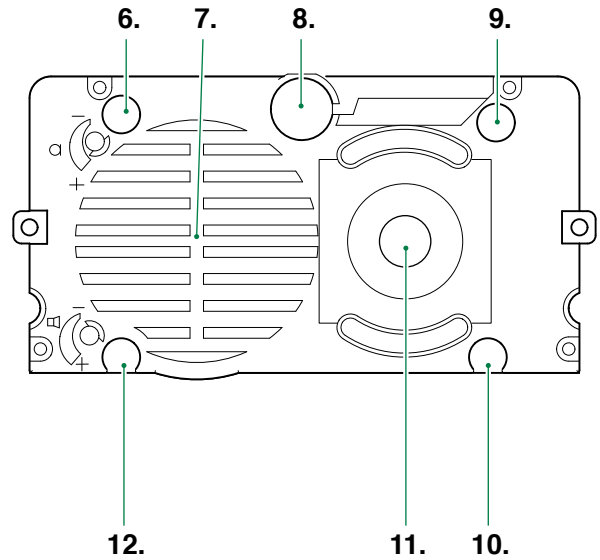
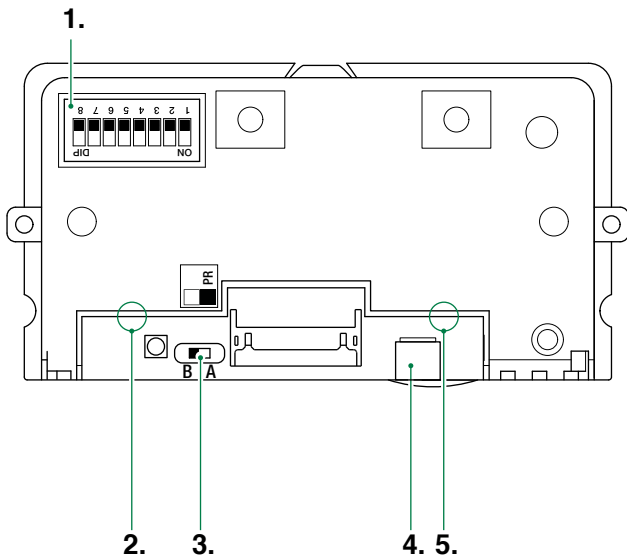

1. Programming DIP-switch for **button module indexing** and **Device reset**
2. Power supply indicator LED
3. **PR** switch for input/output programming
  - A** in programming mode
  - B** normal operation
4. Connector for magnetic induction audio amplification module connection
5. Ethernet port activity indicator LED

6. Indicator LED: call sent
7. Speaker.
8. Microphone.
9. Indicator LED: system busy
10. Indicator LED: sound activated
11. Colour camera.
12. Indicator LED: lock-release activated

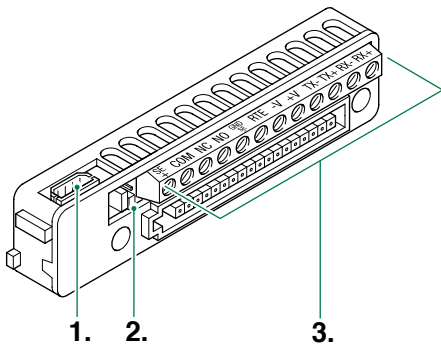

1. Connector for 8-core wire for button module connection
2. **JP1** manages the RC network for door lock filter on the relay contacts (see **“Variant for using the external unit relay / Variant for using a safety lock”**)
3. Terminal block for connection:
 

<b>SE+</b>	connection for electric door lock
<b>COM</b>	relay common contact
<b>NC</b>	relay normally closed contact
<b>NO</b>	relay normally open contact
<b>GND SE-</b>	RTE input and SE door lock reference negative
<b>RTE</b>	local lock-release input
<b>V- V+</b>	+33V or PoE power supply
<b>TX- TX+</b>	Ethernet transmission line terminals
<b>RX- RX+</b>	Ethernet receiving line terminals

# Technical characteristics

## MAIN FEATURES

Audio/video systems	Yes
Induction loop module output	Yes
Camera	Colour
Diagonal viewing angle	125° *
Video encoding	H.264
Camera sensor	1/3" CMOS
Signal/noise ratio (dB)	40
Camera positioning	No
Power supply voltage	30 - 57 / PoE
Consumption in standby	3.0 W
Consumption during call	5.5 W
Consumption with audio active	6.0 W
Terminals	TX- TX+ RX- RX+ V- V+ RTE GND/SE- SE+ COM NC NO
Microphone	Yes
Loudspeaker	Yes
Operating temperature (°C)	-35 to 55

## SW/FW FEATURES

Video resolution (H x V)	1280x720 px MAX #
Multistream management	Yes

## FUCNTION

Key button function	Yes
---------------------	-----

## HARDWARE CHARACTERISTICS

Visual indications	Yes
Acoustic indications	Yes
Voice synthesis	Yes

## ADJUSTMENTS

Loudspeaker volume	Yes (via ViP Manager)
Mic volume	Yes (via ViP Manager)

## GENERAL DATA

Product height (mm)	55
Product width (mm)	102
Product depth (mm)	43

## COMPATIBILITY

ViP system	Yes
Video entry family	Yes

## CONNECTIVITY

Type of connections/ports	Wired
Ethernet ports	on terminals TX- TX+ RX- RX+

## ELECTRICAL SPECIFICATIONS

Relay outputs (C NO NC)	Rated voltage 12VDC/24VAC Maximum rated current 2.5A Max. peak current 15A
Electronic lock (SE GND)	Rated voltage 12VDC Maximum rated current 0.25A Max. peak current 3A
RTE (reference GND)	3.3V

\* With Vandalcom modules Art. 3268S: diagonal viewing angle = 105°

# With Vandalcom modules Art. 3268S: video resolution (H x V) = 1136x640

# External unit installation

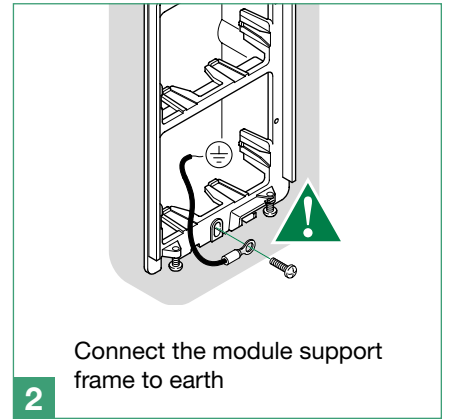
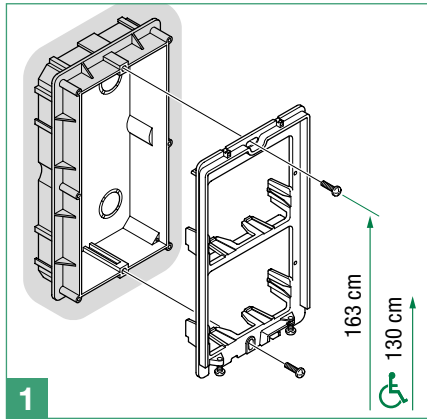
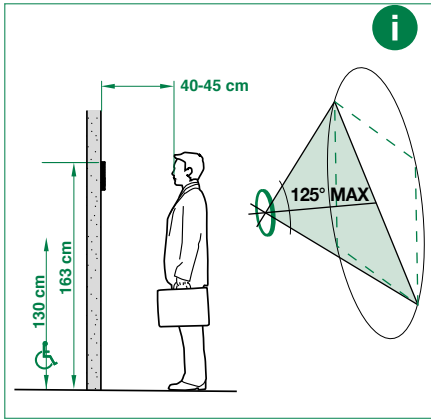

Connect the module support frame to earth

**i** The camera must not be installed in front of light sources, or in places where the filmed subject is against the light. In dim environments, we recommend additional lighting is provided.

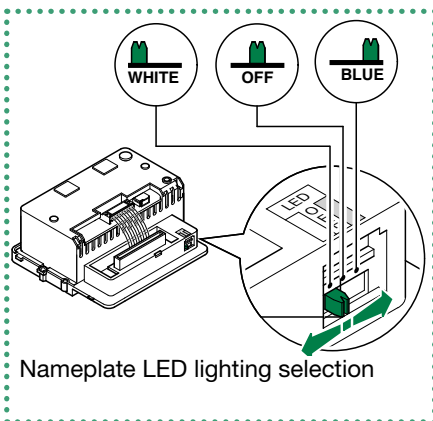
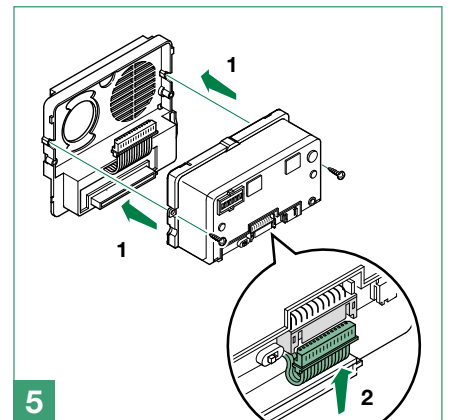
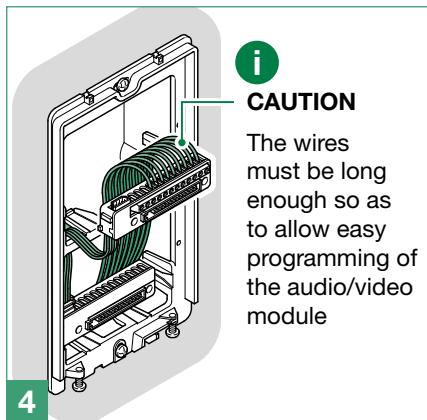
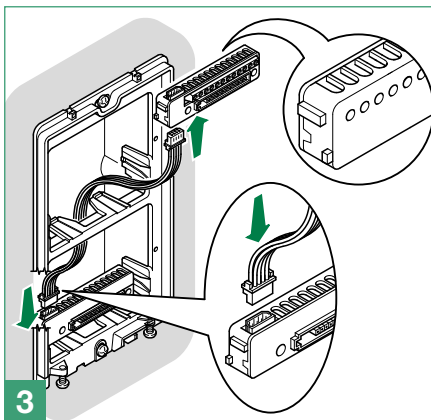

Nameplate LED lighting selection

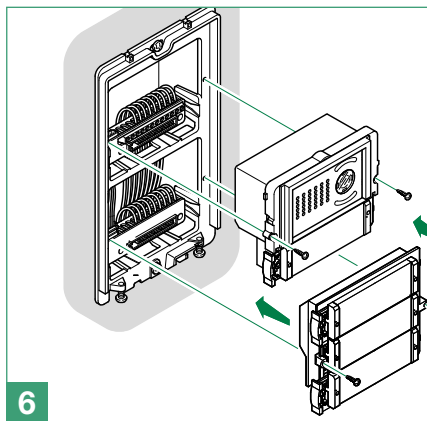

Index the modules before proceeding with installation (see Assigning an index number to the "additional button modules")

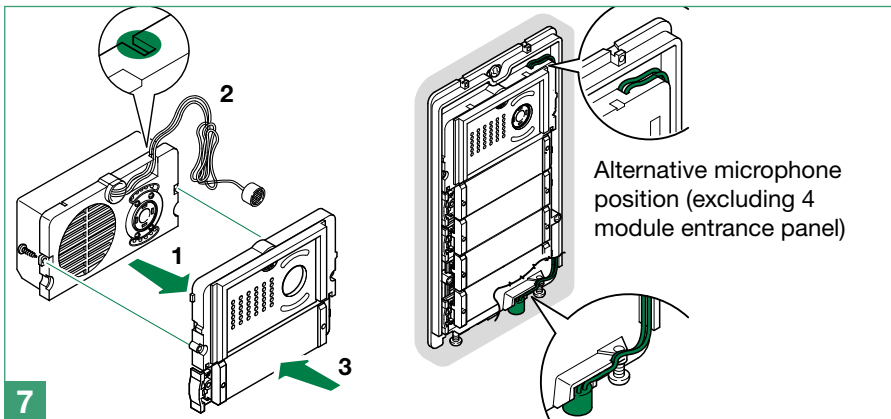

Alternative microphone position (excluding 4 module entrance panel)

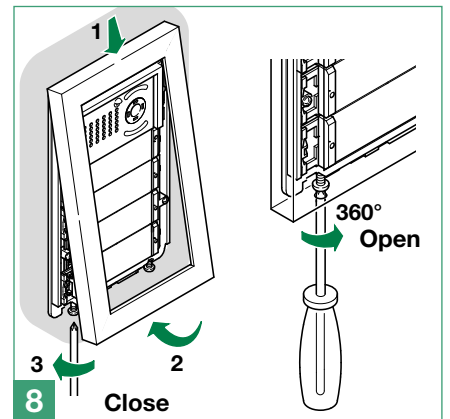

# Connections

## Connection with POE power supply

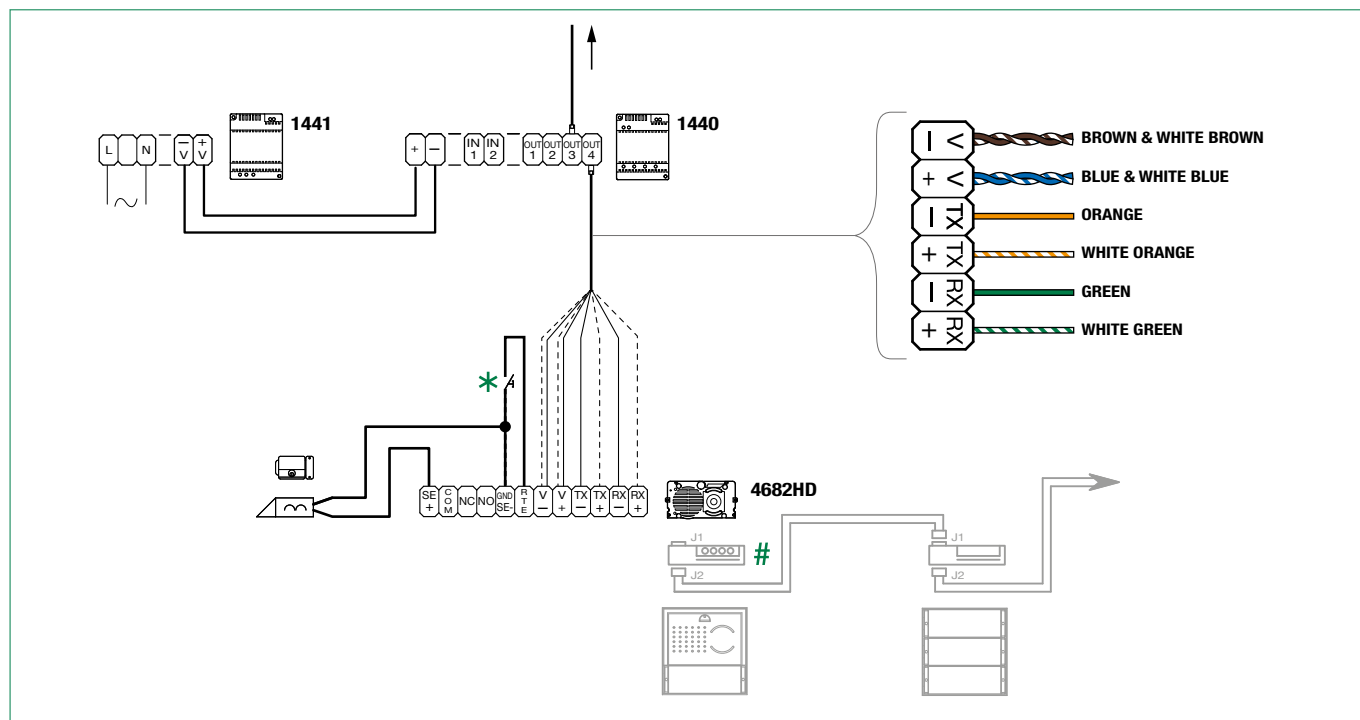

\* Local lock-release button

# For further information on module connection, please refer to [Module Connection](#)

## Connection with additional power supply (Art. 1595)

✓ The additional power supply is necessary when you want to connect additional modules which require a power level greater than 5W in total to the serial port (see [Module Connection](#)).

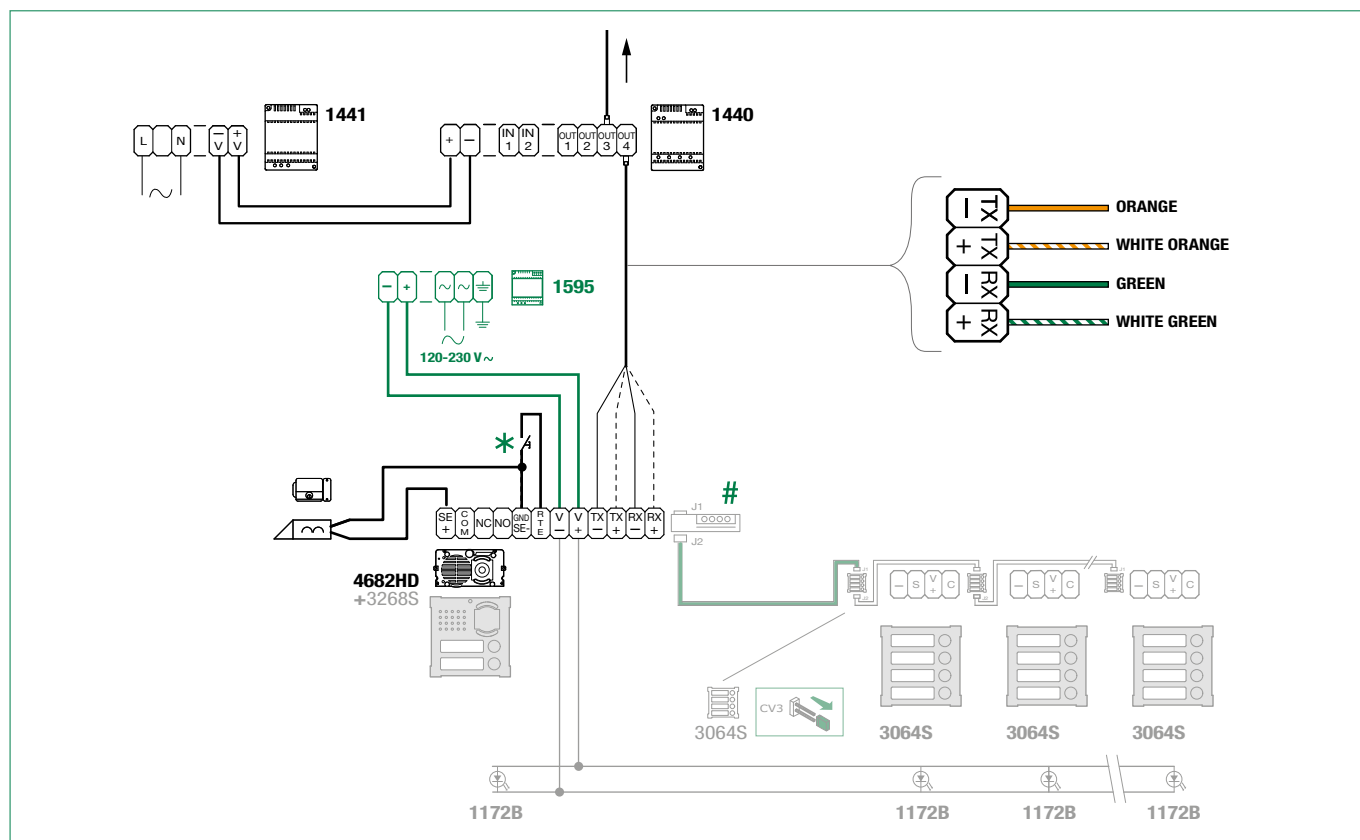

\* Local lock-release button

# For further information on module connection, please refer to [Module Connection](#)

# Variants

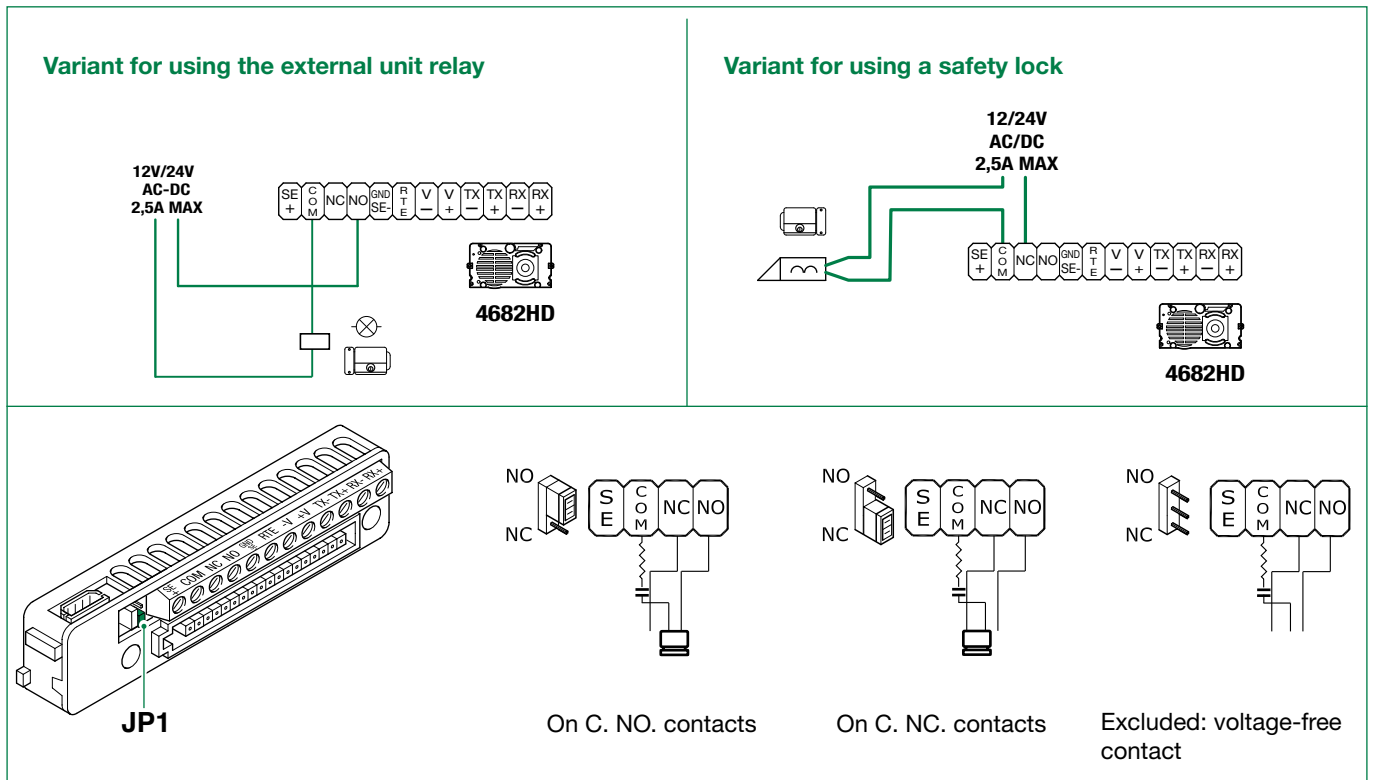

**In case of replacement of a module previously installed, with the Art. 4682HD:**

- ▶ remove the existing terminal block and replace it with the terminal block supplied with item 4682HD

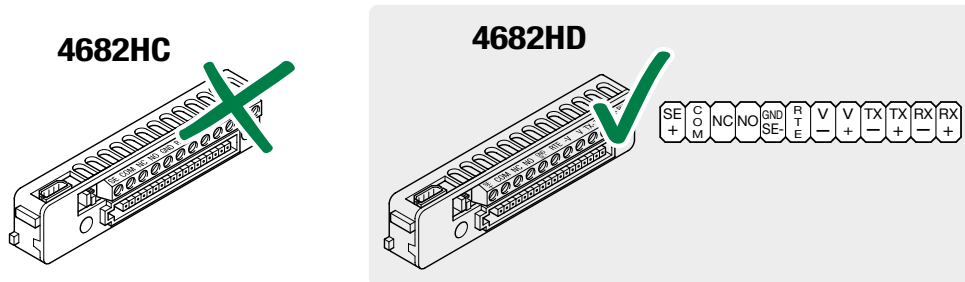

- ▶ connect the 4682HD module as shown in the wiring diagram below.

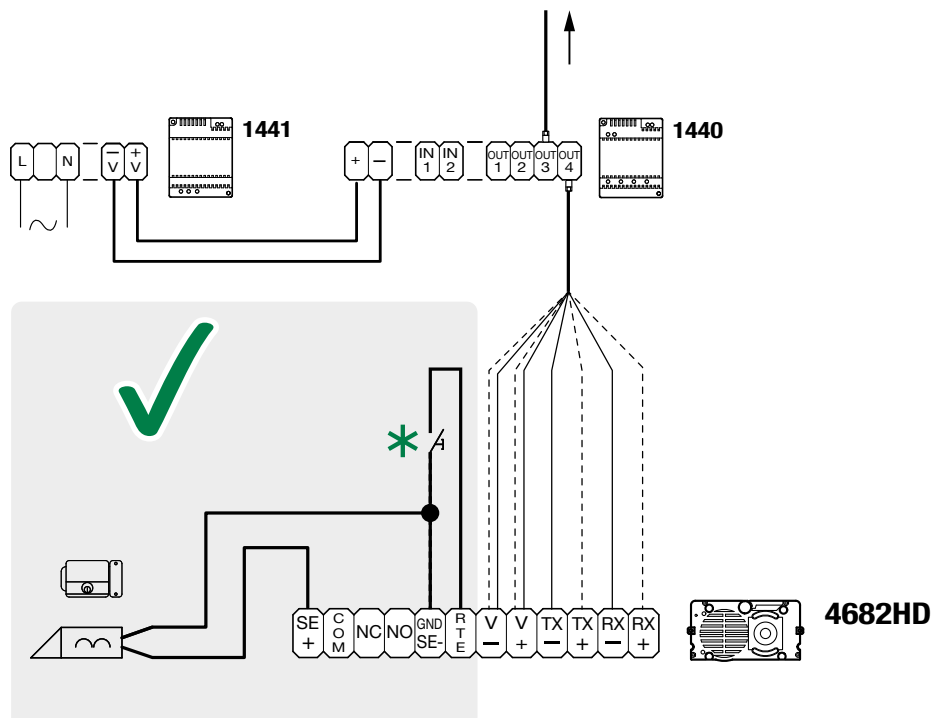



# Module Connection



On systems with Art. 4682HD and Art. 1595, the **MAXIMUM** power available for the additional external unit modules is 10.5W.

On systems with Art. 4682HD and Art. 1440+1441, the **MAXIMUM** power available for the additional external unit modules is 5W.

Calculate the total power consumption of the modules in your system configuration using the Consumption table.

## External unit module consumption table

Code	Consumption	
<b><i>Ikkall modules</i></b>		
33433 / 33434 / 33436 33433M / 33434M / 33436M	0.4W	
3336 / 3336M	0.4W	
3339M	0.4W	
3348B	0.8W	
3348BM	with 1 bistable relay active	1.6W
	with 2 bistable relays active	2.4W
3360B 3060BM	1.7W	
3332 / 3332M	4.0W	
<b><i>Vandalcom modules</i></b>		
3064S (with Art. 1172B)	0.5W	
3070S	2.4W	
3072S	1.8W	
3188SB		0.7W
	with 1 bistable relay active	1.4W
	with 2 bistable relays active	2.1W
<b><i>Modules for Single-plate external unit</i></b>		
3063D (with Art. 1172B)	0.5W	

# Connection of Icall modules

## Connection of button modules 33433, 33434, 33436, 33433M, 33434M, 33436M

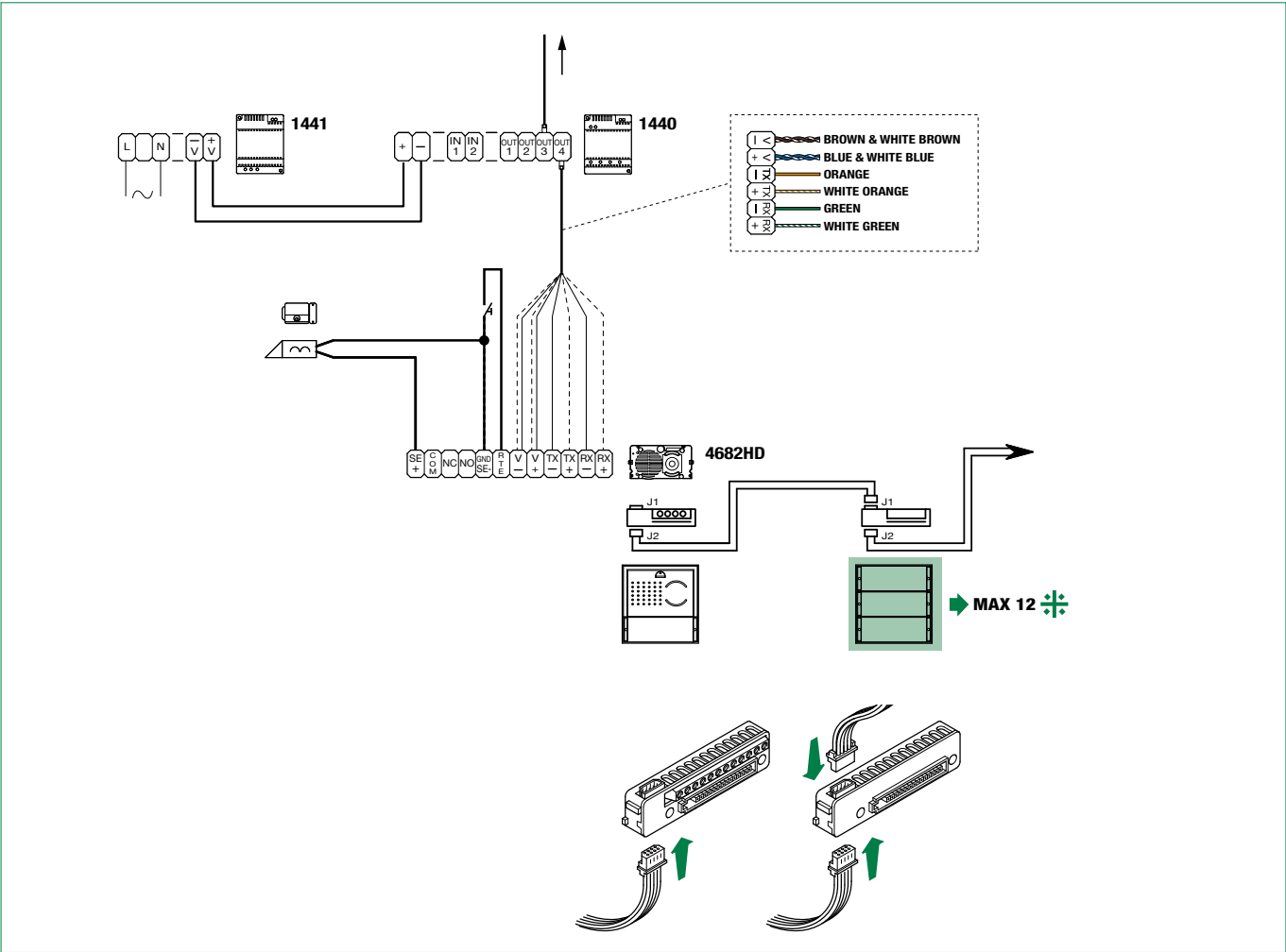

⌘ MAX. 20 modules using [Connection with additional power supply \(Art. 1595\)](#)

## Connection of Art. 3360B, 3360BM

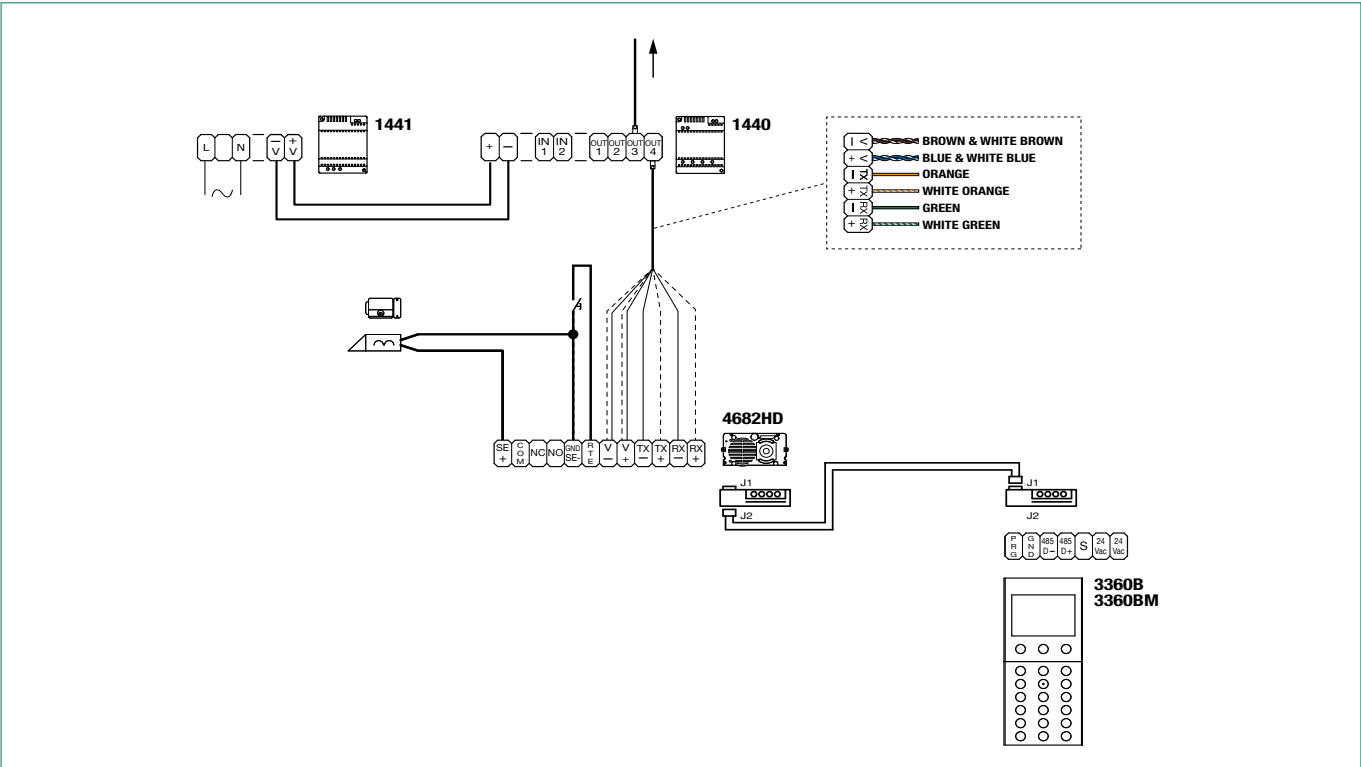

## Connection of Vandalcom modules

### Connection of Art. 3064S and Art. 1172B

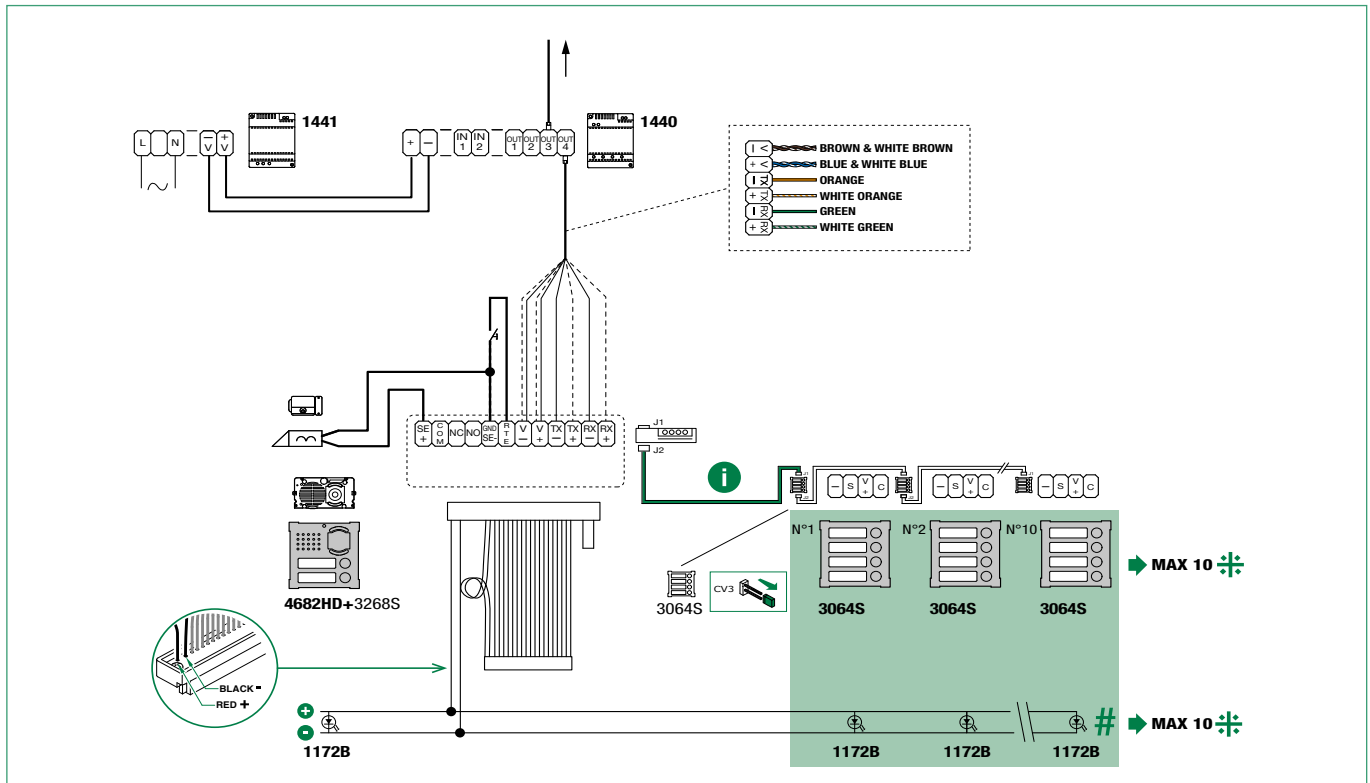

**i** Use the cable supplied with Art. 3268S

# MAX. 20 Art. 3064S plus up to 20 Art. 1172B using [Connection with additional power supply \(Art. 1595\)](#)

# Use bulb Art. 1172B for nameplate lighting. The bulb is polarised

### Connection of Art. 3188SB

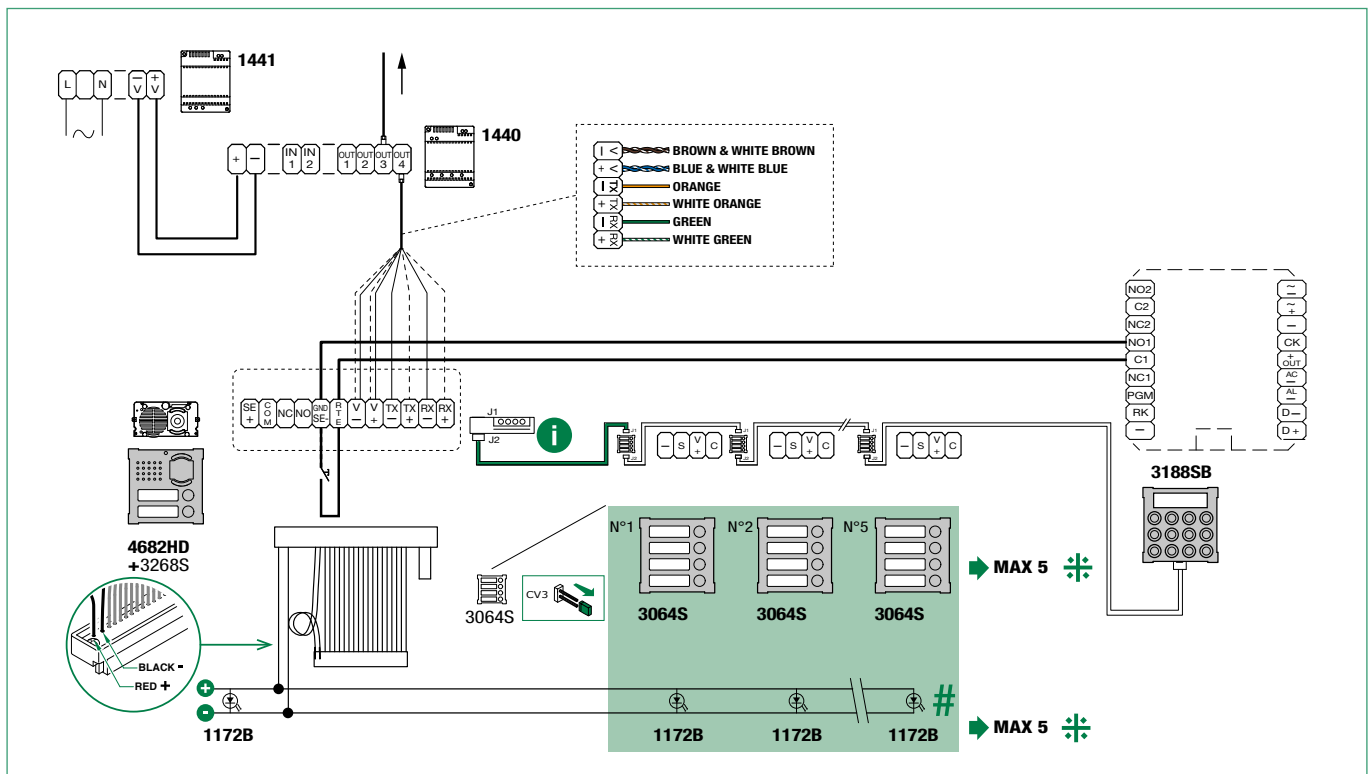

**i** Use the cable supplied with Art. 3268S

# MAX. 18 Art. 3064S plus up to 18 Art. 1172B using [Connection with additional power supply \(Art. 1595\)](#)

# Use bulb Art. 1172B for nameplate lighting. The bulb is polarised.

## Connection of Art. 3070S, 3072S

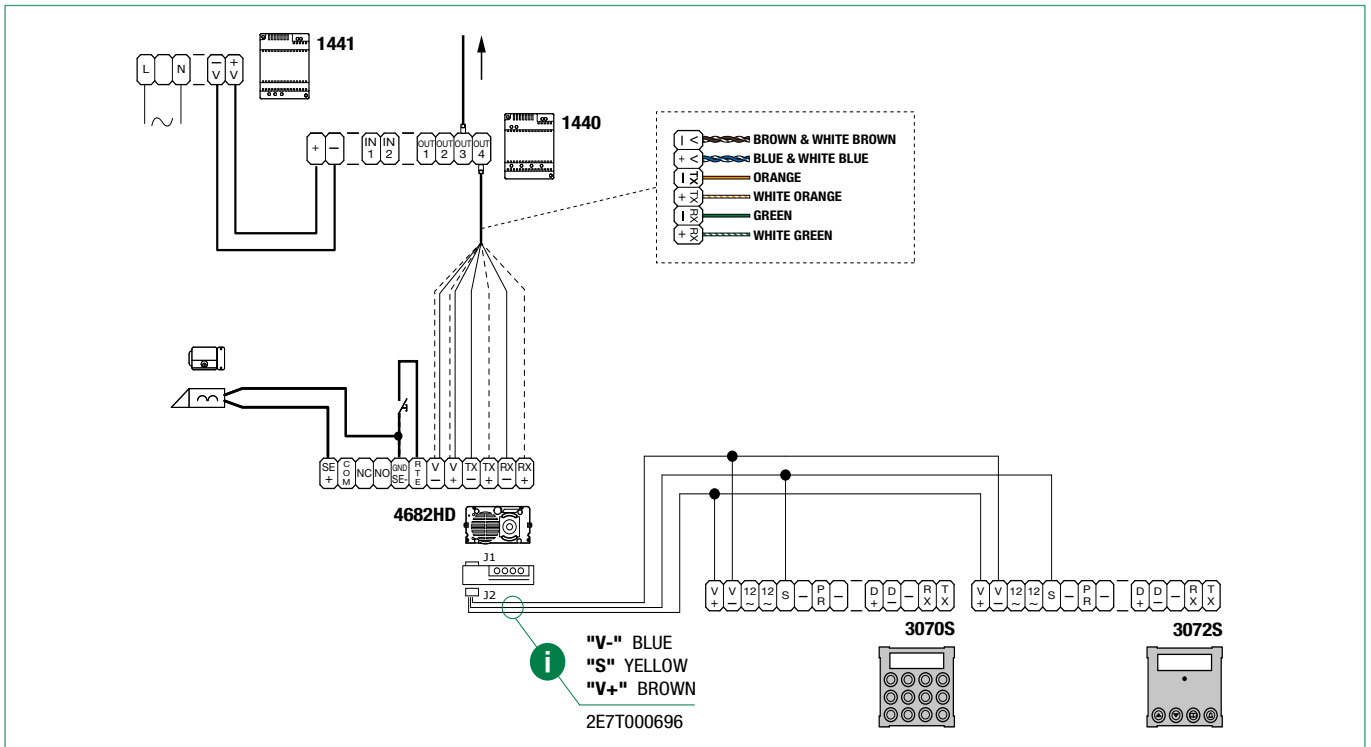

**i** Use the cable 2E7T000696 supplied with Art. 3070S and Art. 3072S

## Modules for Single-plate external unit

### Connection of Art. 3063D with additional power supply

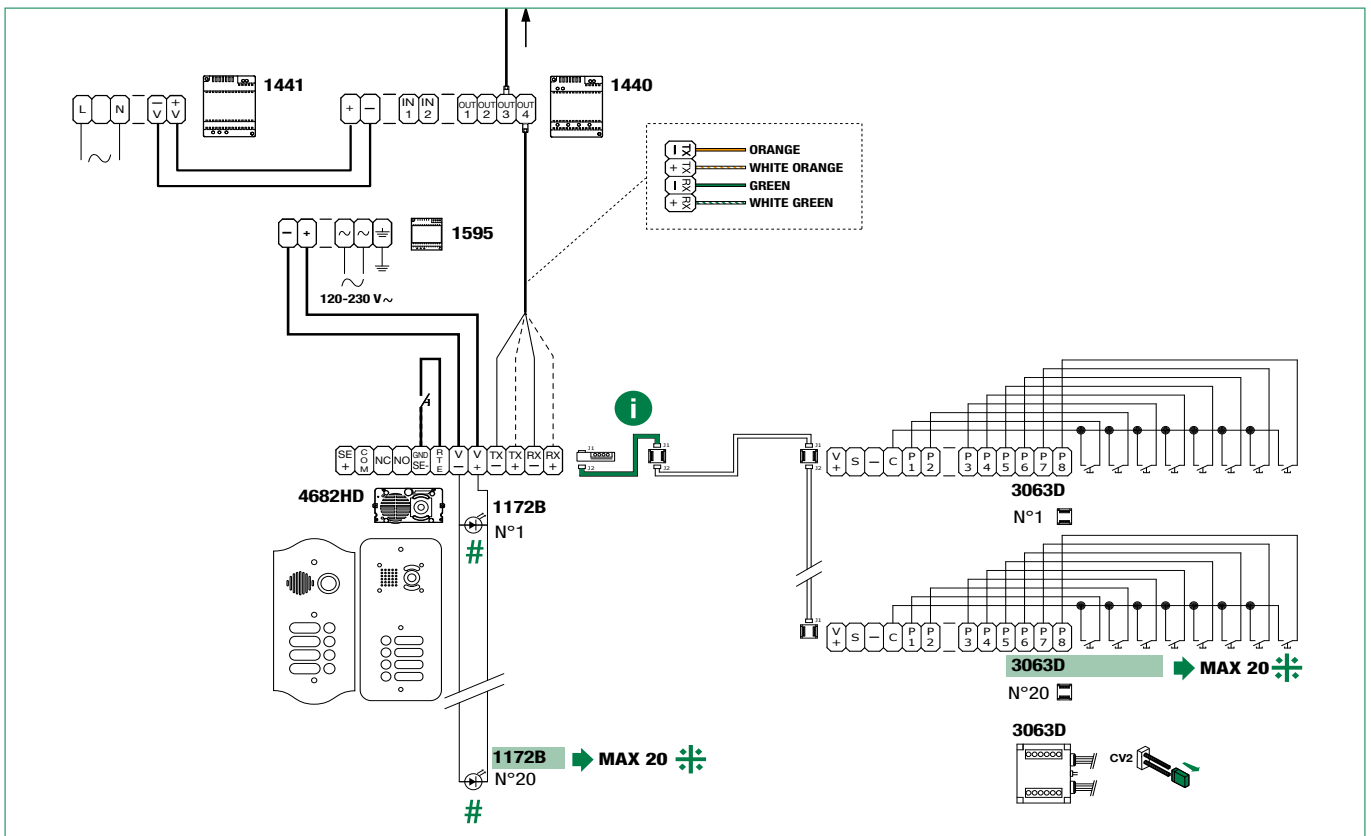

**i** Use the cable included in Art. 1250IV, Art. 1250IA

# MAX. 20 Art. 3063D, plus up to 20 Art. 1172B

# Use bulb Art. 1172B for nameplate lighting. The bulb is polarised

# Simplekey modules

## Connection of readers Art. SK9000I, Art. SK9001I

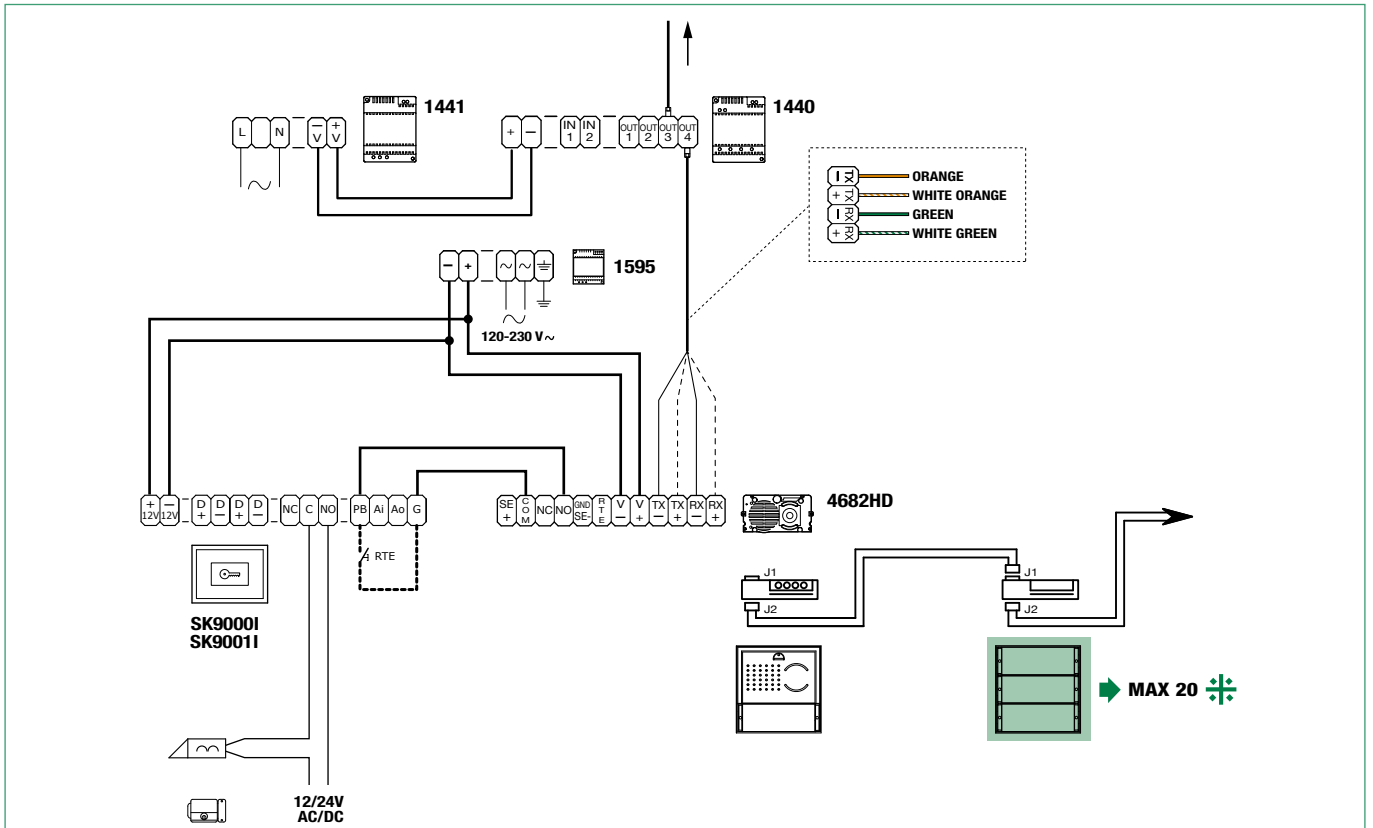

⌘ MAX. 20 modules

# Programming

## Assigning an index number to the “additional button modules”

The following procedure is used to assign an index number to each “additional button module”.

**i** The module index must then be used with the ViP Manager software to complete module button programming (see manual for ViP Manager software).

- ✓ If the module has not yet been powered up, carry out the necessary wiring and wait for the device to start running.
- ▶ Wire the modules and buttons and power up the external unit
  - » after 10 sec. the top right-hand LED lights up
  - ▶ wait for 50 sec. to complete the startup procedure
  - » the LED switches off to confirm completion of the procedure

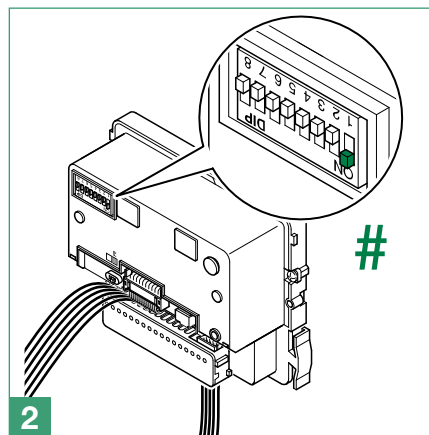
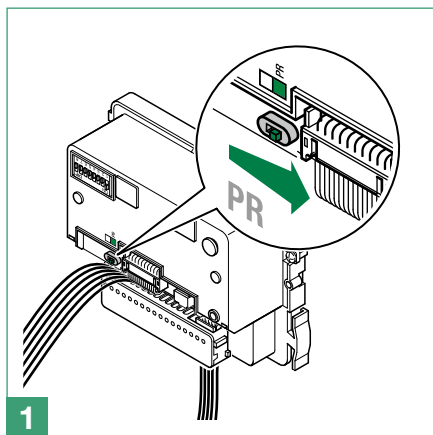
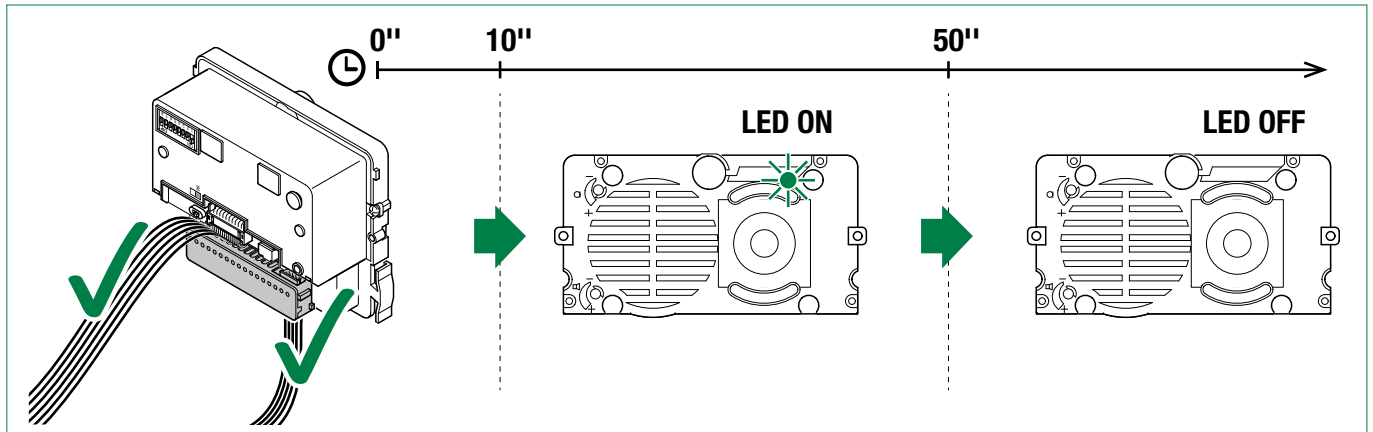

# Set the Index code using the dip switches; see [addressing table](#). Repeat steps 2 and 3 to index each additional button module

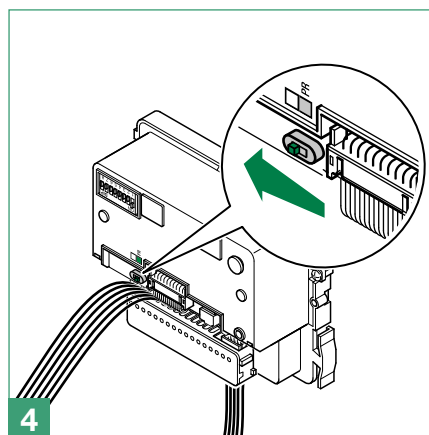
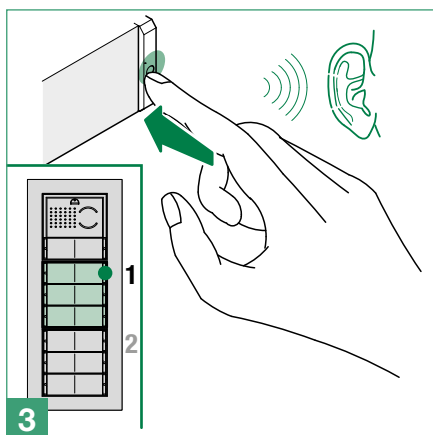

## Addressing table

Code	Dip switch ON	Code	Dip switch ON	Code	Dip switch ON	Code	Dip switch ON	Code	Dip switch ON	Code	Dip switch ON	Code	Dip switch ON	Code	Dip switch ON
1	1	31	1,2,3,4,5	61	1,3,4,5,6	91	1,2,4,5,7	121	1,4,5,6,7	151	1,2,3,5,8	181	1,3,5,6,8	211	1,2,5,7,8
2	2	32	6	62	2,3,4,5,6	92	3,4,5,7	122	2,4,5,6,7	152	4,5,8	182	2,3,5,6,8	212	3,5,7,8
3	1.2	33	1.6	63	1,2,3,4,5,6	93	1,3,4,5,7	123	1,2,4,5,6,7	153	1,4,5,8	183	1,2,3,5,6,8	213	1,3,5,7,8
4	3	34	2.6	64	7	94	2,3,4,5,7	124	3,4,5,6,7	154	2,4,5,8	184	4,5,6,8	214	2,3,5,7,8
5	1.3	35	1,2,6	65	1.7	95	1,2,3,4,5,7	125	1,3,4,5,6,7	155	1,2,4,5,8	185	1,4,5,6,8	215	1,2,3,5,7,8
6	2.3	36	3.6	66	2.7	96	6.7	126	2,3,4,5,6,7	156	3,4,5,8	186	2,4,5,6,8	216	4,5,7,8
7	1,2,3	37	1,3,6	67	1,2,7	97	1,6,7	127	1,2,3,4,5,6,7	157	1,3,4,5,8	187	1,2,4,5,6,8	217	1,4,5,7,8
8	4	38	2,3,6	68	3.7	98	2,6,7	128	8	158	2,3,4,5,8	188	3,4,5,6,8	218	2,4,5,7,8
9	1.4	39	1,2,3,6	69	1,3,7	99	1,2,6,7	129	1.8	159	1,2,3,4,5,8	189	1,3,4,5,6,8	219	1,2,4,5,7,8
10	2.4	40	4.6	70	2,3,7	100	3,6,7	130	2.8	160	6.8	190	2,3,4,5,6,8	220	3,4,5,7,8
11	1,2,4	41	1,4,6	71	1,2,3,7	101	1,3,6,7	131	1,2,8	161	1,6,8	191	1,2,3,4,5,6,8	221	1,3,4,5,7,8
12	3.4	42	2,4,6	72	4.7	102	2,3,6,7	132	3.8	162	2,6,8	192	7.8	222	2,3,4,5,7,8
13	1,3,4	43	1,2,4,6	73	1,4,7	103	1,2,3,6,7	133	1,3,8	163	1,2,6,8	193	1,7,8	223	1,2,3,4,5,7,8
14	2,3,4	44	3,4,6	74	2,4,7	104	4,6,7	134	2,3,8	164	3,6,8	194	2,7,8	224	6,7,8
15	1,2,3,4	45	1,3,4,6	75	1,2,4,7	105	1,4,6,7	135	1,2,3,8	165	1,3,6,8	195	1,2,7,8	225	1,6,7,8
16	5	46	2,3,4,6	76	3,4,7	106	2,4,6,7	136	4.8	166	2,3,6,8	196	3,7,8	226	2,6,7,8
17	1.5	47	1,2,3,4,6	77	1,3,4,7	107	1,2,4,6,7	137	1,4,8	167	1,2,3,6,8	197	1,3,7,8	227	1,2,6,7,8
18	2.5	48	5.6	78	2,3,4,7	108	3,4,6,7	138	2,4,8	168	4,6,8	198	2,3,7,8	228	3,6,7,8
19	1,2,5	49	1,5,6	79	1,2,3,4,7	109	1,3,4,6,7	139	1,2,4,8	169	1,4,6,8	199	1,2,3,7,8	229	1,3,6,7,8
20	3.5	50	2,5,6	80	5.7	110	2,3,4,6,7	140	3,4,8	170	2,4,6,8	200	4,7,8	230	2,3,6,7,8
21	1,3,5	51	1,2,5,6	81	1,5,7	111	1,2,3,4,6,7	141	1,3,4,8	171	1,2,4,6,8	201	1,4,7,8	231	1,2,3,6,7,8
22	2,3,5	52	3,5,6	82	2,5,7	112	5.6,7	142	2,3,4,8	172	3,4,6,8	202	2,4,7,8	232	4,6,7,8
23	1,2,3,5	53	1,3,5,6	83	1,2,5,7	113	1,5,6,7	143	1,2,3,4,8	173	1,3,4,6,8	203	1,2,4,7,8	233	1,4,6,7,8
24	4.5	54	2,3,5,6	84	3,5,7	114	2,5,6,7	144	5.8	174	2,3,4,6,8	204	3,4,7,8	234	2,4,6,7,8
25	1,4,5	55	1,2,3,5,6	85	1,3,5,7	115	1,2,5,6,7	145	1,5,8	175	1,2,3,4,6,8	205	1,3,4,7,8	235	1,2,4,6,7,8
26	2,4,5	56	4,5,6	86	2,3,5,7	116	3,5,6,7	146	2,5,8	176	5,6,8	206	2,3,4,7,8	236	3,4,6,7,8
27	1,2,4,5	57	1,4,5,6	87	1,2,3,5,7	117	1,3,5,6,7	147	1,2,5,8	177	1,5,6,8	207	1,2,3,4,7,8	237	1,3,4,6,7,8
28	3,4,5	58	2,4,5,6	88	4,5,7	118	2,3,5,6,7	148	3,5,8	178	2,5,6,8	208	5,7,8	238	2,3,4,6,7,8
29	1,3,4,5	59	1,2,4,5,6	89	1,4,5,7	119	1,2,3,5,6,7	149	1,3,5,8	179	1,2,5,6,8	209	1,5,7,8	239	1,2,3,4,6,7,8
30	2,3,4,5	60	3,4,5,6	90	2,4,5,7	120	4,5,6,7	150	2,3,5,8	180	3,5,6,8	210	2,5,7,8	*240	5,6,7,8

### EXAMPLE setting code 200

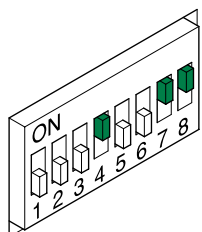

## Device reset

The reset procedure restores the factory settings of the external units, deleting all settings implemented by the installer.

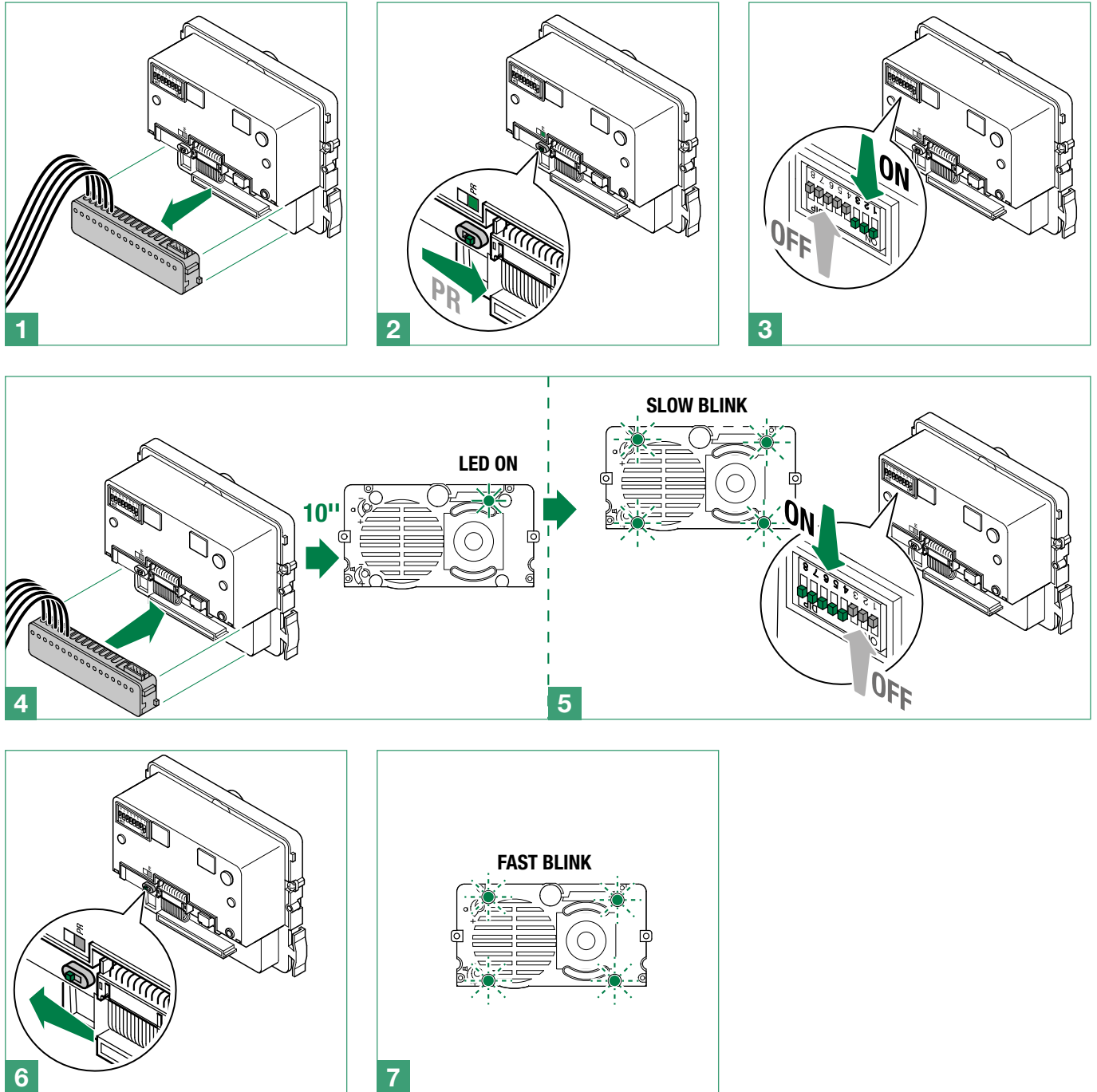



# Connection distances

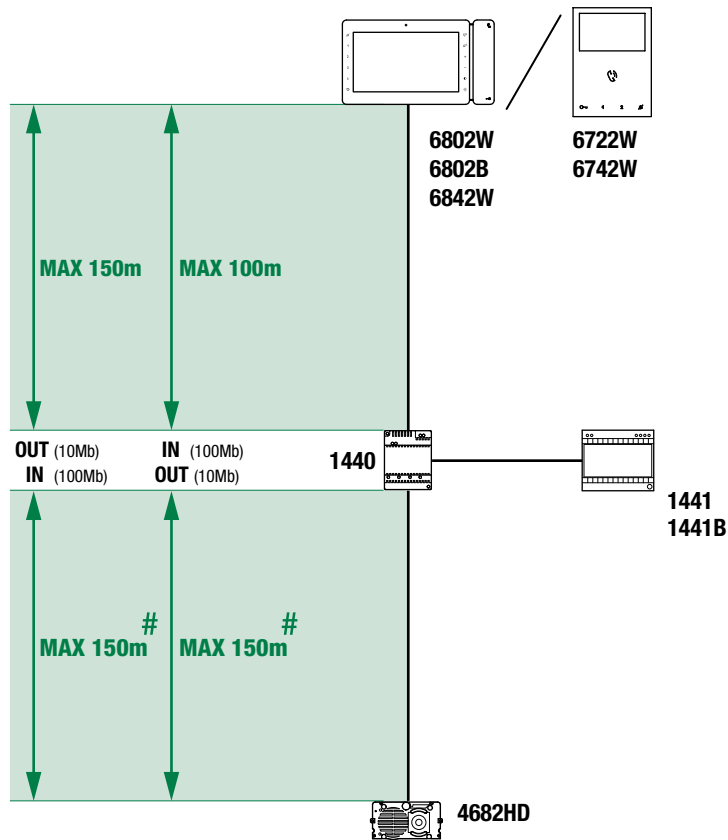

# If Art.4682HD is powered directly from third-party standard POE switches, the maximum distance is reduced to 100 m.

CERTIFIED MANAGEMENT SYSTEMS



[www.comelitgroup.com](http://www.comelitgroup.com)

Via Don Arrigoni, 5 - 24020 Rovetta (BG) - Italy

