



Model Selection Guide



CM-324 1 Relay, Line Powered

Ideal for economical door activation where a door or locked status indicator is not required.

These switches feature an operating range of 1-30" and an adjustable time delay of 1-5 seconds, providing superior performance in ambient lighting conditions.



CM-325 1 Relay, Short Range

Ideal for short range sensing in confined areas such as in restrooms.

These switches are designed for use in healthcare and facilities where highly reflective surfaces (chrome or polished stainless steel) cause standard switches to false activate.



CM-330 Battery Powered

Ideal for door activation where installing wiring is difficult or expensive, and for instant replacement of non-powered switches in retrofit applications.

These switches offer the longest alkaline battery life of any switch in the market, with the option for lithium batteries. CM-RX90 receiver required.



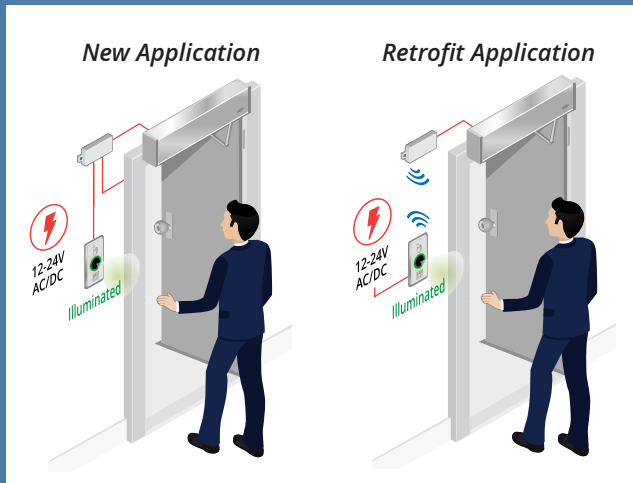

CM-331 1 Relay

Includes option for Light Ring and Wireless Transmitter

New Application

Ideal for activation and control, where door status indication is required. This eliminates the need for a separate door control relay.

Retrofit Application

Ideal for replacement of non-powered switches, without battery maintenance. Re-use 2 existing wires for power and optional CM-TX99 plug-in wireless transmitter to activate door opening.

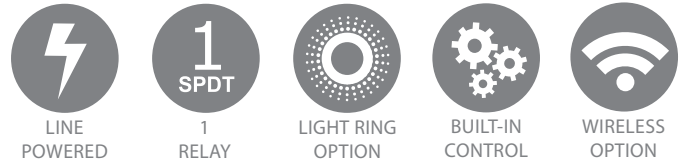

CM-332 2 Relays, Line Powered

Includes option for Light Ring and Wireless Transmitter

Ideal for activation and control of two doors, particularly vestibule applications. This eliminates the need for a separate door control relay.

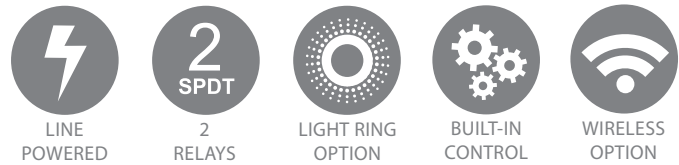

CM-333 1 Relay, Hybrid Battery Powered

Designed to retrofit non-powered push plate switches with sensor switches without any additional wiring.

These switches offer the longest alkaline battery life of any switch in the market, with the option for lithium batteries.



Opening New Doors to Innovation, Quality and Support!



For a complete list of all SureWave™ Touchless Switch Kits, please visit camdencontrols.com