

XPass 2

Outdoor Compact RFID Device



XPass 2 is an outdoor compact RFID device based on Suprema's state-of-the-art RFID technology and multi-hardware platform. With the multi-form factor technology, mullion-type, gangbox-type, and gangbox keypad-type are all supported which provides perfect installation in various environments. XPass 2 also supports dual-frequency (125kHz / 13.56MHz) RFID technology and can read the mobile cards using NFC and BLE, the latest mobile communication technologies. Packed in a rugged IP65/IP67 rated dust & waterproof performance as well as IK08 rated vandal-proof structure, suitable for tough environment and outdoor installation.

Features

-  **Mobile Access**
-  **OSDP** Industry standard communication via OSDP
-  **Multi-type hardware structure**
-  **Enhanced security with the Secure Element**
-  **IP67 - Water and Dust Resistant**
-  **IK08 - Vandal Resistant**
-  **Multi-card Reading**
-  **Power over Ethernet**

Specifications

125kHz card compatibility	EM
13.56MHz card compatibility	MIFARE, MIFARE Plus, DESFire EV1/EV2*, FeliCa
CPU	1.0GHz
Memory	4GB Flash + 64MB SDRAM
Max. Users	200,000
Max. Text Logs	1,000,000
Mobile card	NFC, BLE
IP rating	IP67
IK rating	IK08
Installation type	Mullion: XP2-MDPB Gangbox: XP2-GDPB, XP2-GKDPB
Keypad	Not Supported: XP2-MDPB, XP2-GDPB Supported (3x4): XP2-GKDPB
Ethernet	Supported (10/100 Mbps, auto MDI/MDI-X)
RS-485	1ch Master or Slave
Wiegand	1ch In or Out
TTL	2ch Input
Relay	1 Relay
PoE	Supported (IEEE 802.3af compliant)
Sound	Multi-tone buzzer
Operating Temperature	-35°C ~ 65°C
Operating Humidity	0% ~ 95%, non-condensing
Power	DC 12V or DC 24V
Dimensions (WxHxD, mm)	48 x 145 x 27: XP2-MDPB 80 x 130 x 25: XP2-GDPB, XP2-GKDPB
Certificates	CE, FCC, KC, RoHS, REACH, WEEE, SIG

* DESFire EV2 cards are supported by having backward compatibility of DESFire EV1 cards. CSN and smart card functions are compatible with XPass 2.

System Configurations

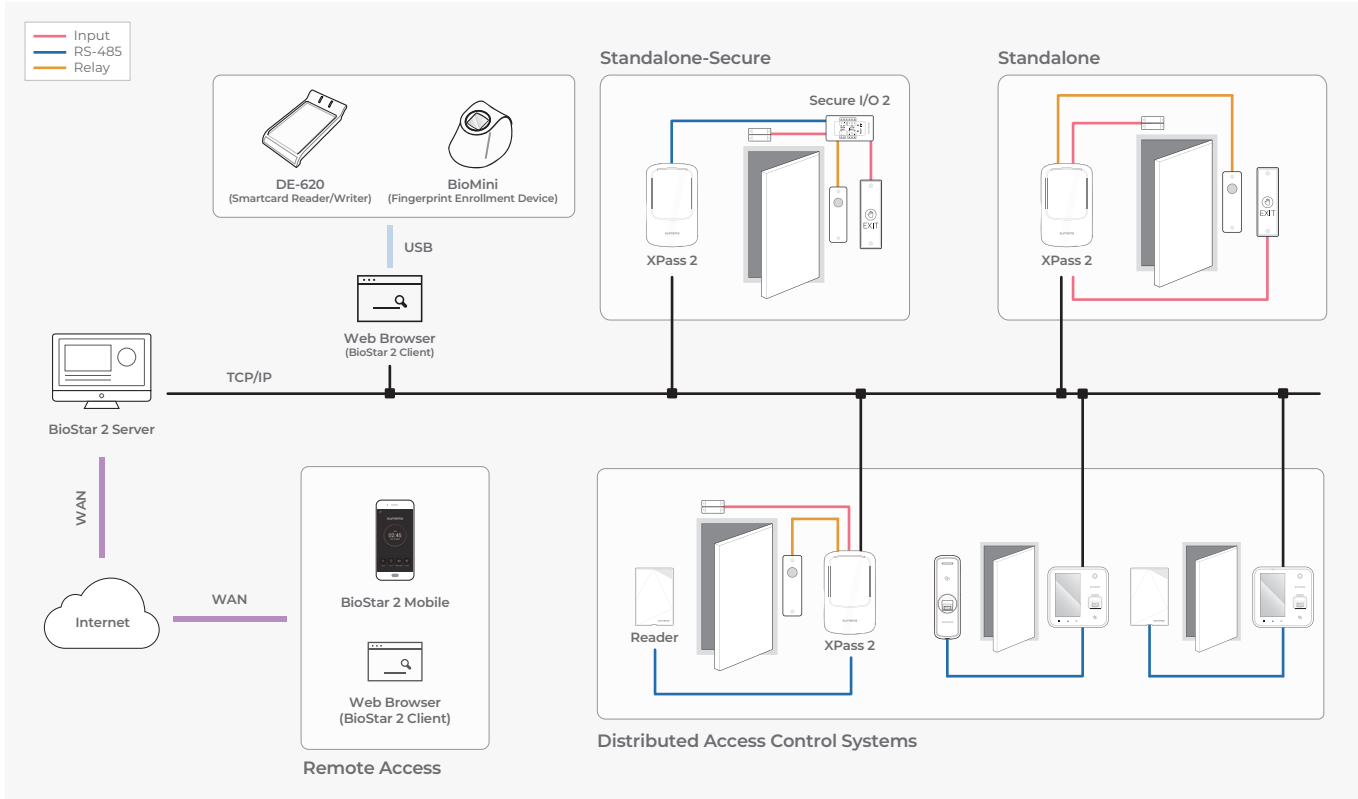

Suprema Inc.

17F Parkview Tower, 248, Jeongjail-ro, Bundang-gu, Seongnam-si, Gyeonggi-do, 13554, Republic of Korea
 T +82 31 783 4502 E sales_sys@supremainc.com www.supremainc.com



For more information about Suprema's global branch offices, visit the webpage below by scanning the QR code.
<https://www.supremainc.com/en/about/contact-us.asp>