

55EW5TF-A

Transparent OLED Touch Signage

55" EAN CODE: 55EW5TF-A - 8806098681754

55EW5TF-A

A New Level of "See-Through View" Imagination becomes reality

LG Transparent OLED Touch Signage brings light to spaces that once were hidden away behind the display, harmonizing its surroundings. With its touch functionality, it has the usage potential for various applications where customers can interact.

Key Features

- Brightness(Typ.): 400 cd/m² (APL 25%, without Glass)
- Transparency(Typ.) : 33% (Set)
- Bezel : 7.9 mm (T/B/L), 144.5 mm (B)
- Interface : HDMI / DP / USB 2.0(2) / Touch USB / RS232C / RJ45/ IR / Audio
- P-Cap Touch, Tempered Front Glass (3T)



Specification - 55EW5TF-A

55EW5TF-A

Panel	Screen Size	55"	
	Panel Technology	OLED	
	Native Resolution	1,920 x 1,080 (FHD)	
	Brightness (Typ.)	150 / 400 nit (APL 100% / 25 %, Without Glass)	
	Contrast Ratio	150,000 : 1	
	Dynamic CR	No	
	Color Gamut	BT709 120 %	
	Viewing Angle (H x V)	178 x 178	
	Color Depth	1.07 Billion Colors (10bit)	
	Response Time	1 ms (G to G)	
	Surface Treatment (Haze)	No	
	Operation Hours (Hours / Day)	18 / 7 (Moving Content Only)	
	Portrait / Landscape	Yes / Yes	
	Transparency	33% (Set)	
Connectivity	Input	HDMI (HDCP 2.2), DP (HDCP 1.3), USB 2.0 Type A, USB 2.0 Type A (Touch Control Board Only)	
	Output	DP, Audio, USB 2.0 Type B (Touch USB)	
	External Control	RS232C In / Out, RJ45 (LAN) In / Out, IR In (External IR Receiver)	
Mechanical Specification	Bezel Color	Matt Silver	
	Bezel Width	7.9 / 7.9 / 7.9 / 144.5 mm (T/R/L/B)	
	Weight (Head)	14.6 kg (Head) / 3.4 kg (Signage Box)	
	Monitor Dimensions (W x H x D)	1,225.5 x 832.9 x 7.0 mm (Head) 782.8 x 238.4 x 34.7 mm (Signage Box)	
	Monitor Dimensions with Stand (W x H x D)	No	
	VESA™ Standard Mount Interface	No	
	Protection Glass	Depth	3.0 mm
		Tempered / Chemical Strengthening	Yes
Anti-Reflective		Yes	
Shatter-Proof	Yes		
Key Features	Internal Memory (16GB), Temperature Sensor, FAN, webOS 4.0, Embedded CMS (Local Contents Scheduling, Group Manager), USB Plug & Play, Fail Over, Video Tag (4), Rotation (Screen Rotation), Gapless Playback, Setting Data Cloning, SNMP, ISM Method, Auto Set ID, Status Mailing, Control Manager, Crestron Connected ^{®1)} , PM Mode, Wake on LAN, HDMI-CEC ^{™2)} , SI Server Setting, Prodiom		
Environment Conditions	Operation Temperature	0 °C to 40 °C	
	Operation Humidity	10 % to 80 %	
Power	Power Supply	AC 100 - 240 V ~, 50 / 60 Hz	
	Power Type	Built-in Power	
	Power Consumption	Typ. / Max. 250 W / 280 W BTU (British Thermal Unit) 853 BTU/Hr (Typ.), 955 BTU/Hr (Max.)	
Sound	Speaker	No	
Certification	Safety	CB, NRTL	
	EMC	FCC Class "A" / CE / KC	
	ErP	Yes (EU Only)	
Media Player Compatibility	OPS Type Compatible	No	
	OPS Power Built In	No	
Software Compatibility	SuperSign CMS, SuperSign Control / Control+, SuperSign Media Editor, Signage365Care ³⁾		
Accessories (Basic)	Remote Controller, Power Cord, QSG, IR Receiver, Regulation Book, Phone to RS232C Gender, FCC Cables (1,600 mm x 4 ea for Connection Between Panel and Signage Box), HDMI Cable (3 M), Micro to A Type USB Cable (1.8 M for Connection Between Touch and Signage Box), A to B Type USB Cable (Touch Out), Tape (10 ea for Cabling / 10 ea EMI Gasket Tape), Screw (M4 x L22, 12 ea / M4 Nut 12 ea / M3 x L5.5, 8 ea / M3 x L3.5, 20 ea), Shield Cover Ass'y, Rubber Damper 4 ea, Touch Cable Holder 2 ea		

¹⁾ Network based control ²⁾ Compatibility may differ by equipment. ³⁾ The availability can differ by region.

* Specification are subject to change without notice, so please contact LG sales team to verify before ordering.

Dimenisons (unit: mm)

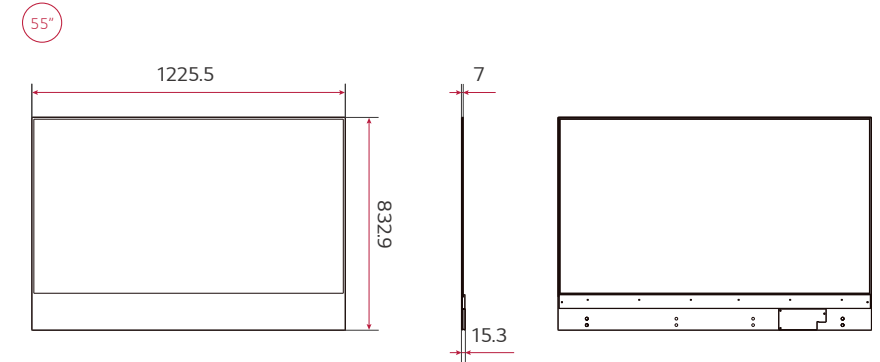

Connectivity

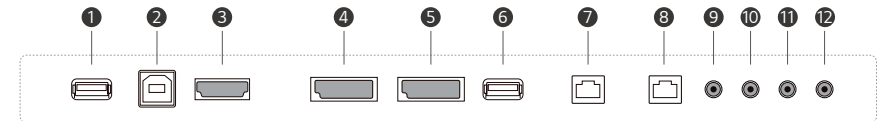

- 1 TOUCH USB IN
- 2 TOUCH OUT (PC)
- 3 HDMI IN
- 4 DP IN
- 5 DP OUT
- 6 USB IN (USB 2.0)
- 7 LAN IN
- 8 LAN OUT
- 9 IR IN
- 10 RS-232C IN
- 11 RS-232C OUT
- 12 AUDIO OUT



* Dimensions & Jack Panels (Read/Side) may differ from the above image, so please contact LG sales team to verify before ordering.



- www.lg.com/b2b
- www.youtube.com/c/LGCommercialDisplay
- www.facebook.com/LGInformationDisplay
- www.linkedin.com/company/LGInformationDisplay



LG may make changes to specifications and product descriptions without notice.
Copyright © 2019 LG Electronics Inc. All rights reserved. "LG Life's Good" is a registered trademark of LG Corp.
The names of products and brands mentioned here may be the trademarks of their respective owners.