



## Starling Tab-Tension 2 Series Product Brochure

High quality tab-tensioned front projection motorized screen. It has an elegant arcuate shaped aluminum housing that allows floating baskets to attach to the back for a quick easy installation. The Starling Tab-Tension 2 is the ideal projection screen for professional applications with an improved motor speed.



# Starling Tab-Tension 2 Series



High quality tab-tensioned front projection motorized screen. It has an elegant arcuate shaped aluminum housing that allows floating brackets to attach to the back for a quick easy installation.

## Screen Material:

- Spectra White FG (fiberglass backed) matte white surface
- CineWhite® matte white projection material (Only for 135" Models)
- 4K Ultra HD, Active 3D, and HDR Ready
- Standard black masking borders and black backing
- Extra top black masking border for high ceiling installation
- Available in the following diagonal sizes:
  - 100", 120", 135" and 150" in 16:9 format

## Design and Installation:

- Elegant arcuate shaped case in white or black finish
- Floating brackets allow easy wood stud alignment for a wall or ceiling installation
- Mounting hardware kit included
- Wall mountable remote control cradle included
- Plug & Play ready, no hardwire installation required

## Control System:

- Internal Radio Frequency/Infrared receivers with IR, RF remotes included
- Infrared IR "eye" extension sensor - ideal for concealed installation but still require Infrared control
- 12 volt trigger capable for synchronized screen operation with the projector's power cycle
- Manual control UP/DOWN buttons on exterior of case
- Smooth and quiet operation
- RS-232 capable for serial communication

## Quality and Reliability:

- Tubular motor allows swift operation with a superior weight tolerance and operational lifespan
- Low power consumption
- Flame Retardant: Complies with NFPA 701 Standards
- 2-year manufacturer's warranty
- 3rd year warranty offered through ENR-G program (Education, Non-Profit, Religious, and Government/Military)



## Starling Tab-Tension 2 Series

Model	Screen Diag. & Aspect Ratio	View Height (in)	View Width (in)	View Height (cm)	View Width (cm)	N.W. (lbs.)	G.W. (lbs.)	N.W. (kgs)	G.W. (Kgs)	Packaging Dimensions (LxWxH)	Gain	Screen Material	Case Color
STT100UWH2-E24	100"(16:9)	49.0	87.2	124.5	221.4	46.3	65.3	21.0	29.6	112"x8.9"x7.7"	1.1	Spectra White FG	Black
STT100XWH2-E24	100"(16:9)	49.0	87.2	124.5	221.4	46.3	65.3	21.0	29.6	112"x8.9"x7.7"	1.1	Spectra White FG	White
STT120UWH2-E14	120"(16:9)	58.8	104.5	149.4	265.7	52.9	74.5	24.0	33.8	129.1"x8.9"x7.7"	1.1	Spectra White FG	Black
STT120XWH2-E14	120"(16:9)	58.5	104.5	148.6	265.7	52.9	74.5	24.0	33.8	129.1"x8.9"x7.7"	1.1	Spectra White FG	White
STT150UWH2-E6	150"(16:9)	73.6	130.7	186.9	332.0	67.5	92.6	30.6	42.0	155"x8.9"x7.7"	1.1	Spectra White FG	Black
STT150XWH2-E6	150"(16:9)	73.6	130.7	186.9	332.0	67.5	92.6	30.6	42.0	155"x8.9"x7.7"	1.1	Spectra White FG	White
STT100XWH2-E12	100"(16:9)	49.0	87.2	124.5	221.4	46.3	65.3	21.0	29.6	112"x8.9"x7.7"	1.1	CineWhite®	White
STT120UWH2-E12	120"(16:9)	58.9	104.5	149.4	265.7	52.9	74.5	24.0	33.8	129.1"x8.9"x7.7"	1.1	CineWhite®	Black
STT120XWH2-E12	120"(16:9)	58.9	104.5	149.4	265.7	52.9	74.5	24.0	33.8	129.1"x8.9"x7.7"	1.1	CineWhite®	White
STT135UWH2-E6	135"(16:9)	66.2	117.7	168.1	298.9	58.2	81.6	26.3	37.0	143"x8.9"x7.7"	1.1	CineWhite®	Black
STT135XWH2-E6	135"(16:9)	66.2	117.7	168.1	299.0	58.2	81.6	26.3	37.0	143"x8.9"x7.7"	1.1	CineWhite®	White

## Starling Tab-Tension 2 Series Dimensions Table

Model Number	Screen Diag. & Aspect Ratio	Case Length (A)	Bracket Distance (A1)	Screen Width (A2)	Viewable Width (A3)	Weight Bar (A4)	Overall Height (B)	Screen Height (B1)	Viewable Height (B2)	Bottom Border (B3)	Top Black Border (B4)	Top Black Border (B4)
STT100UWH2-E24	100"(16:9)	103.9	72.4	94.1	87.2	96.3	81.4	75.1	49.0	2.3	23.8	24.0
STT100XWH2-E24	100"(16:9)	103.9	72.4	94.1	87.2	96.3	81.4	75.1	49.0	2.3	23.8	24.0
STT120UWH2-E14	120"(16:9)	121.3	89.8	111.4	104.5	113.6	81.2	74.9	58.9	2.3	13.8	14.0
STT120XWH2-E14	120"(16:9)	121.3	89.8	111.4	104.5	113.6	81.2	74.9	58.9	2.3	13.8	14.0
STT150UWH2-E6	150"(16:9)	147.4	100.2	137.6	130.7	139.8	88.1	81.8	73.6	2.3	5.9	6.0
STT150XWH2-E6	150"(16:9)	147.4	100.2	137.6	130.7	139.8	88.1	81.8	73.6	2.3	5.9	6.0

Unit: mm

Model Number	Screen Diag. & Aspect Ratio	Case Length (A)	Bracket Distance (A1)	Screen Width (A2)	Viewable Width (A3)	Weight Bar (A4)	Overall Height (B)	Screen Height (B1)	Viewable Height (B2)	Bottom Border (B3)	Top Black Border (B4)	Top Black Border (B4)
STT100UWH2-E24	100"(16:9)	2640	1840	2389	2215	2445	2068	1908	1245	58	605	605
STT100XWH2-E24	100"(16:9)	2640	1840	2389	2215	2445	2068	1908	1245	58	605	605
STT120UWH2-E14	120"(16:9)	3080	2280	2829	2655	2885	2063	1903	1495	58	350	350
STT120XWH2-E14	120"(16:9)	3080	2280	2829	2655	2885	2063	1903	1495	58	350	350
STT150UWH2-E6	150"(16:9)	3745	2545	3494	3320	3550	2238	2078	1870	58	150	150
STT150XWH2-E6	150"(16:9)	3745	2545	3494	3320	3550	2238	2078	1870	58	150	150

Unit: inch

**Note: Data Error ±1".** The listed measurements are for general reference only. Please contact Elite Screens to verify product design and dimensions before attempting to integrate its products with any structural or furniture modification. Although a manufacturer may offer product advice, it may be taken or disregarded at the integrator's discretion. Elite Screens will not be held responsible or be otherwise liable for faulty installations.

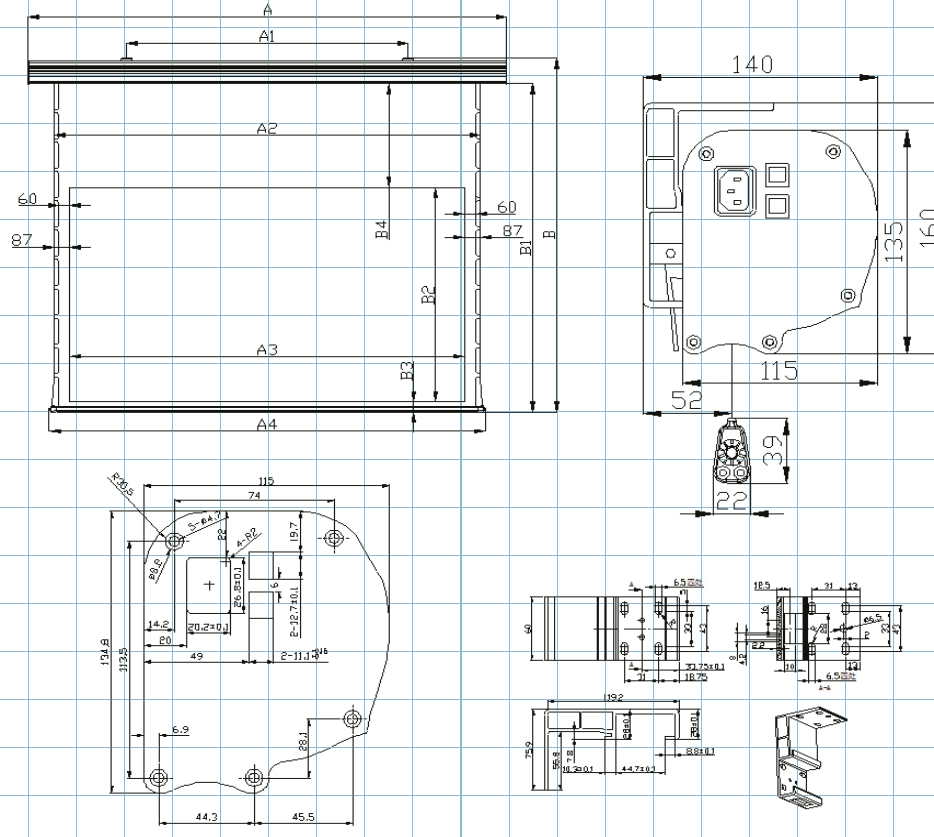

### Starling Tab-Tension 2 Series Dimensions (CineWhite® Models)

Model Number	Screen Diag. & Aspect Ratio	Case Length (A)	Bracket Distance (A1)	Screen Width (A2)	Viewable Width (A3)	Weight Bar (A4)	Overall Height (B)	Screen Height (B1)	Viewable Height (B2)	Bottom Border (B3)	Top Black Border (B4)	Top Black Border (B4)
STT100XWH2-E12	100"(16:9)	106.7	73.8	94.1	87.2	96.3	69.4	63.3	49.0	2.3	12.0	12.0
STT120UWH2-E12	120"(16:9)	124.1	91.1	111.4	104.5	113.6	79.3	73.1	58.9	2.3	12.0	12.0
STT120XWH2-E12	120"(16:9)	124.1	91.1	111.4	104.5	113.6	79.3	73.1	58.9	2.3	12.0	12.0
STT135UWH2-E6	135"(16:9)	135.8	96.5	124.6	117.7	126.8	80.6	74.3	66.1	2.3	6.0	6.0
STT135XWH2-E6	135"(16:9)	135.8	96.5	124.6	117.7	126.8	80.6	74.3	66.1	2.3	6.0	6.0

Unit: mm

Model Number	Screen Diag. & Aspect Ratio	Case Length (A)	Bracket Distance (A1)	Screen Width (A2)	Viewable Width (A3)	Weight Bar (A4)	Overall Height (B)	Screen Height (B1)	Viewable Height (B2)	Bottom Border (B3)	Top Black Border (B4)	Top Black Border (B4)
STT100XWH2-E12	100"(16:9)	2710	1875	2390	2215	2446	1763	1608	1245	58	305	305
STT120UWH2-E12	120"(16:9)	3152	2314	2830	2654	2885	2014	1857	1496	58	305	305
STT120XWH2-E12	120"(16:9)	3152	2314	2830	2654	2885	2014	1857	1496	58	305	305
STT135UWH2-E6	135"(16:9)	3449	2451	3165	2990	3221	2047	1887	1680	58	152	152
STT135XWH2-E6	135"(16:9)	3449	2451	3165	2990	3221	2047	1887	1680	58	152	152

Unit: inch

**Note: Data Error ±1".** The listed measurements are for general reference only. Please contact Elite Screens to verify product design and dimensions before attempting to integrate its products with any structural or furniture modification. Although a manufacturer may offer product advice, it may be taken or disregarded at the integrator's discretion. Elite Screens will not be held responsible or be otherwise liable for faulty installations.

