

## Efficient Cable Management and Installation

Hubbell Premise Wiring's VME Series Vertical Cable Managers provide efficient and effective cable management to support and secure your cabling infrastructure and ensure optimal network performance in today's Mission Critical<sup>®</sup> applications. The VME vertical managers build on the features and design of the VM series and are updated with targeted front and rear capacity for mid to large size cabling requirements to optimize storage space with overall footprint. The VME is designed to maximize installation efficiency during both assembly to the relay rack and cabling. Durable metal construction ensures cables are protected and supported throughout their life cycle. The VME managers provide an efficient solution to manage your end-to-end Hubbell Premise Wiring cabling system.

### Specifications

- 80.5" height for 84"/45 RU racks and frames
- 6" wide, 14" overall depth
- Steel construction with aluminum doors
- Front: C-shaped 6" W x 7.23" D-channel with L-shaped cable guides every 2 RU
- Rear: (5) 6" W x 6.3" D cable rungs and (6) 6" D spools
- Front cover included with all units; VME614C2 includes full height rear cover; VME614C1 includes swinging gate covers for the rear rungs



### Features

- Front cable guides spaced every two rack units make it easier to route patch cables, align with two rack unit panels/horizontal managers, and improve air flow while effectively managing and supporting the cables
- Cable guides welded to the frame for strength
- In the rear, open design helps route cable bundles, ensures good air flow, and allows flexibility to deploy management where you need it
- Hinging covers reversible to hinge left or right
- Front to back pass thru openings at any height
- VME flush mounts with HM 4" horizontals for a clean appearance

### Installation Efficiency

- Unpack and install in two to three minutes
- Main channel ships fully assembled
- Simple, quick component assembly
- Quick attach hooks secure the manager in place while bolting it to the rack
- Covers and swing gates hinge out of the way during cabling
- Cable management design and features make it easier to route cables



# VME Series Vertical Cable Managers

## Vertical Cable Managers

7'H x 6"W x 14"D; front C channel

Description	Color	Catalog No.
(5) rear cable rungs; (6) spools; front and rear cover	Black	<b>VME614C2</b>
(5) rear cable rungs; (6) spools; front cover, rear gate covers	Black	<b>VME614C1</b>

### Capacity

Front Area: 39 in<sup>2</sup>; Rear Area: 30 in<sup>2</sup>

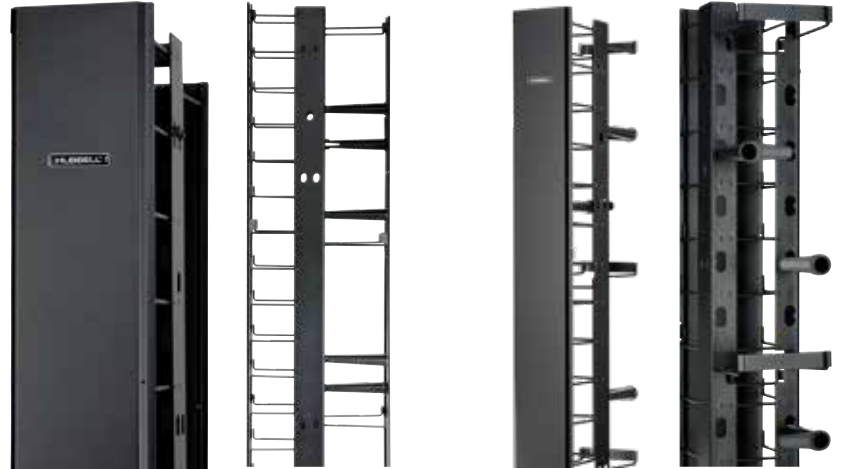
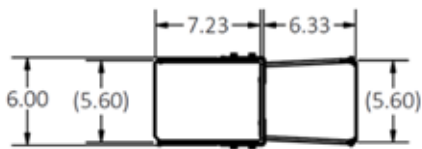

VME614C2

VME614C1

### Compatible Relay Racks and Server Frames

3" Deep, 45 RU Relay Rack	<b>HPW84RR19</b>
6" Deep, 45 RU Relay Rack	<b>HPW84RR19D</b>
10" Extra Deep, 45 RU Relay Rack	<b>HHR45U10</b>
16" Extra Deep, 45 RU Relay Rack	<b>HHR45U16</b>
SF84 Series 4 Post Racks	<b>SF8419yy*</b>

Standard M6 cage nut

\*Add **T** for #12-24 Threaded

**yy** = Depth (in) (**24, 29, 36, 42, 48**)



### Suggested Horizontal Cable Managers

VME Flush Mount with HM 4" Front Depth

RU	Description	Catalog No.
1	4" front depth, hinging front cover	<b>HM14C</b>
2	4" front depth, hinging front cover	<b>HM24C</b>
2	4" front, 7" rear depth, hinging front cover	<b>HM247C</b>



### Accessories

Description	Catalog No.
VME Series, 7'H x 6"W cover, Black	<b>VME6C</b>
VME Series rear gate kit (5)	<b>VME614GK</b>

### VME Series Fill Chart

	HCL Patch Cords 0.19" OD	HC6 Patch Cords 0.23" OD	HC6A Patch Cords 0.29" OD	Cat 6 Link 0.20" OD	Cat 6 Mid 0.225" OD	Cat 6A 0.27" OD
<b>VME Front Channel</b> C Shaped Channel, 38.9 sq in	536	370	232	486	389	268
<b>VME Rear Channel</b> Rungs and Gates, 30.2 sq in	416	287	180	377	302	208

40% Fill Rate Capacity