

Professional Wi-Fi CPE Network Bridge Installation Guide

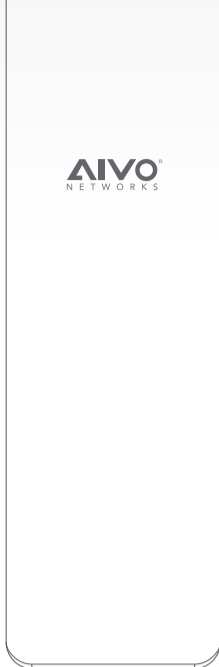

www.aivonet.com

1 Contents



Main Device

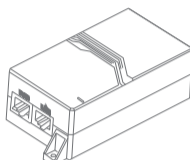

PoE Power Adapter



Mounting Straps

2 Optional Accessories

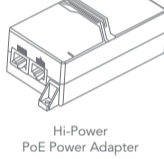

Hi-Power
PoE Power Adapter

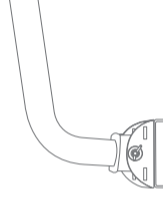

Multi Angle
Metal Bracket

3 Interface Description

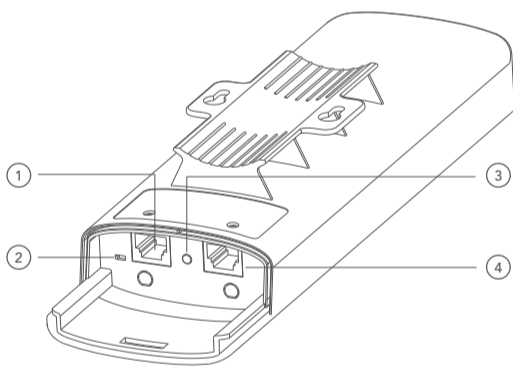

- ① LAN Port (PoE can be turned On/Off)
- ② PoE Power Switch for LAN Port
- ③ Reset Button
- ④ PoE Enabled WAN Port

4 Schematic Diagram of Typical Connection

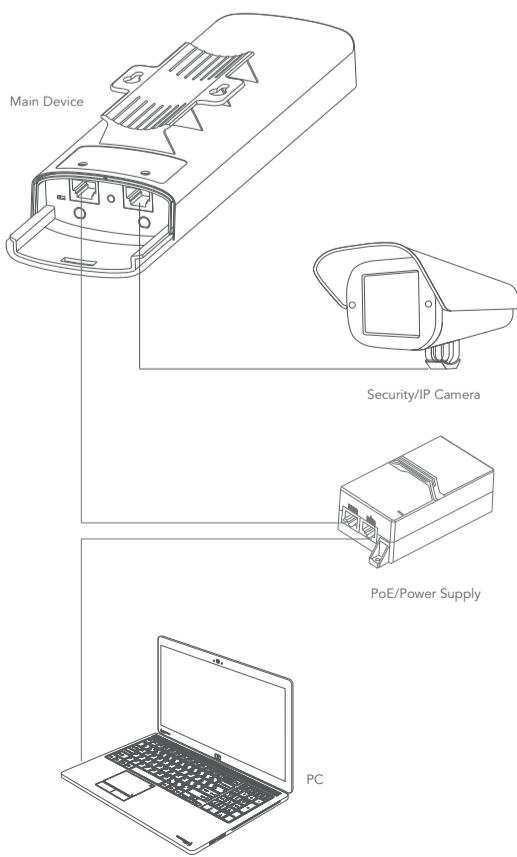

5 Installation Guide

- ① Slide two mounting straps (A) into two slots (B) on the mounting bracket as shown on the picture

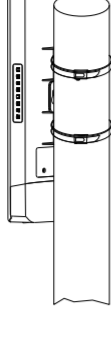
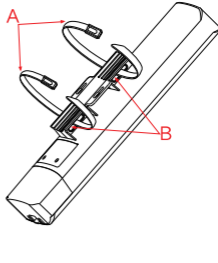

- ② Attach the mounting straps (A) around the pole as shown, using the plier tight both ends of strap

- ③ Press the latch button (E) to slide open the cover (C). Connect the cables accordingly and close the cover.

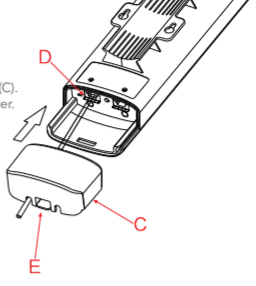

6 Installation Guide with Multi Angle Mounting Bracket

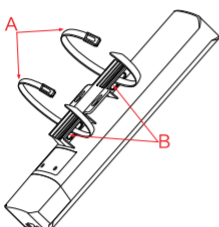

- ① Slide two mounting straps (A) into two slots (B) on the mounting bracket as shown on the picture.

- ② First, attach Multi Angle Mounting Bracket to the pole using two mounting straps as shown in the picture, and attach the mounting straps (A) to the bracket. Using the plier, tight all the mounting strap ends.

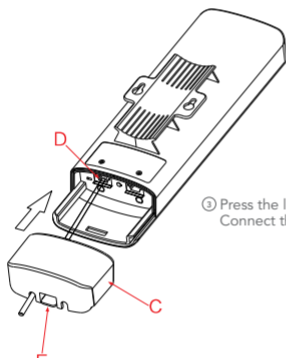
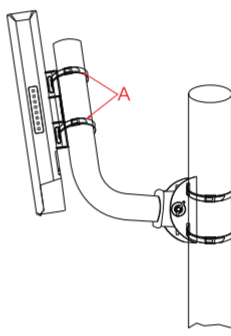

- ③ Press the latch button (E) to slide open the cover (C). Connect the cables accordingly and close the cover.

7 Installation Guide with Screws

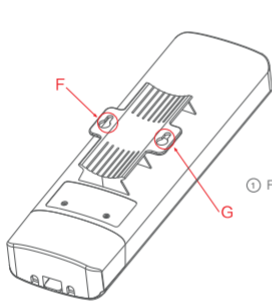

- ① Find two screw keyholes (F),(G) on the bracket

- ② After precisely place the screws on the wall, slide over the keyholes (F), (G) to mount.

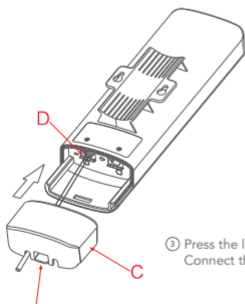

- ③ Press the latch button (E) to slide open the cover (C). Connect the cables accordingly and close the cover.

Copyright Information

Statement

Big Cart Corporation Company all rights reserved.

Without our official written permission, no unit or individual shall be copied, reproduced, transcribed or translated in part or whole book. In any form or by any means (electronic, mechanical, printing, recording or other possible means) or for the propagation of goods any commercial, profitable purposes.

AIVO® is the registered trademark of Big Cart Corporation Company in California, United States. All other trademarks or registered trademarks mentioned in this document, by respective owners.

Product specifications and information mentioned in this manual are for reference on subject to updates without notice. Unless there are other special agreed, this manual is used only as a user guide.

All statements, information, etc. are not constitute anyform of guarantee