



FWMP-24

24 Fiber Optic Wall-Mount Panel
 Holds Up To (1) Fiber Adapter Plates

24F Fiber Optic Wall Mount Panel

1) Features

- A) Wall mounted Box;
- B) Max. Capacity is 24FO if for with 1 adapter panels of 6 ports of LC quad cutting;
 Max. Capacity is 12FO is for with 1 adapter panels of 6 ports of SC duplex cutting;
 Max. Capacity is 12FO is for with 1 adapter panels of 12 ports of ST/FC cutting;
- C) Optional for RAL7035 or RAL9005, and RoHS compliant;

2) Dimension for Body and Panel

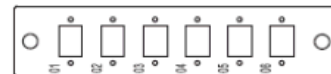
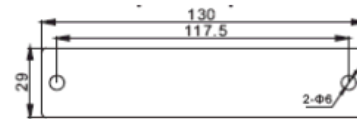
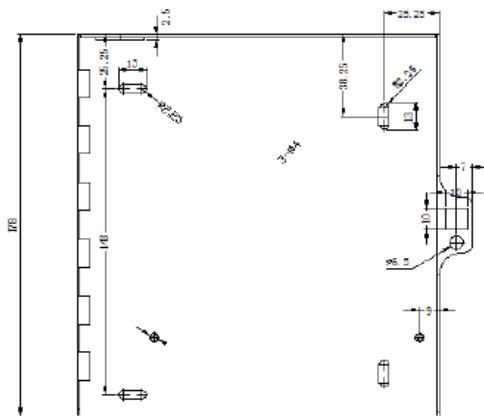
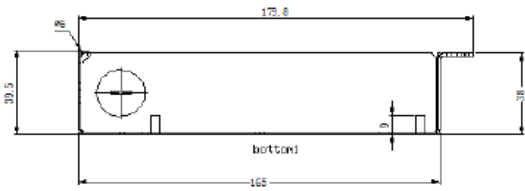

Blank Panel



SC /LCD 6ports



SCD/LCQ 3ports



SCD/LCQ 6ports

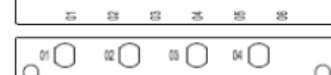

ST/FC 6ports

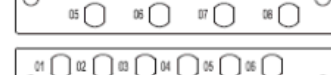

ST/FC 8ports

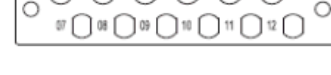

ST/FC 12ports

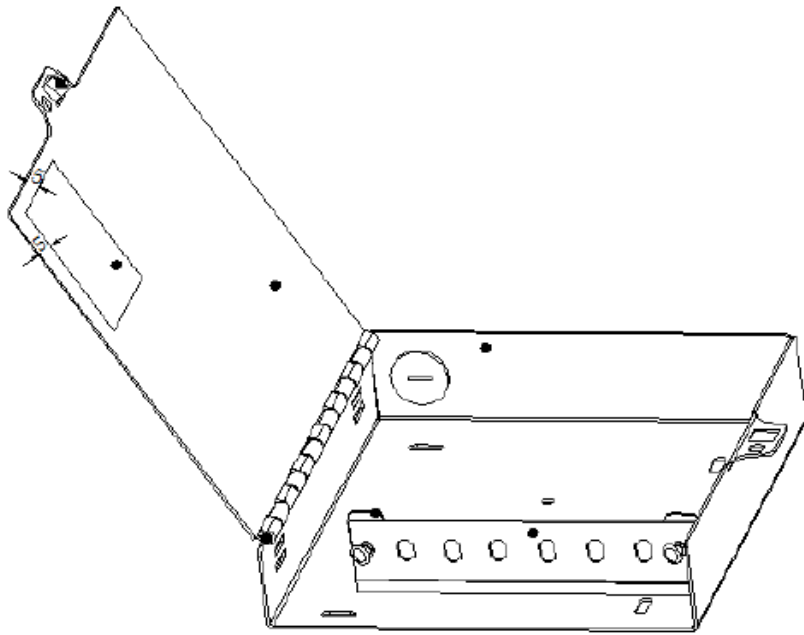

Plastic latch



1 pc