

## EBA1540

5-Megapixel True Day/Night  
Outdoor IR Ball Camera

eZ.HD



## Features

- 5MP Sony STARVIS CMOS sensor, delivering amazing high sensitivity
- 3.6mm fixed lens with ICR to capture the desired field of view
- Extended IR range of up to 20m /66ft. with 18 LEDs (depends on scene IR reflectivity)
- T-WDR to improve the visibility under high contrast scene
- The flexible angle viewing with its 3-Axis rotation design allows wall or ceiling mounting
- IP66-rated with metal housing
- Supports UTC function: Control camera OSD settings directly from DVR end

## Dimensions

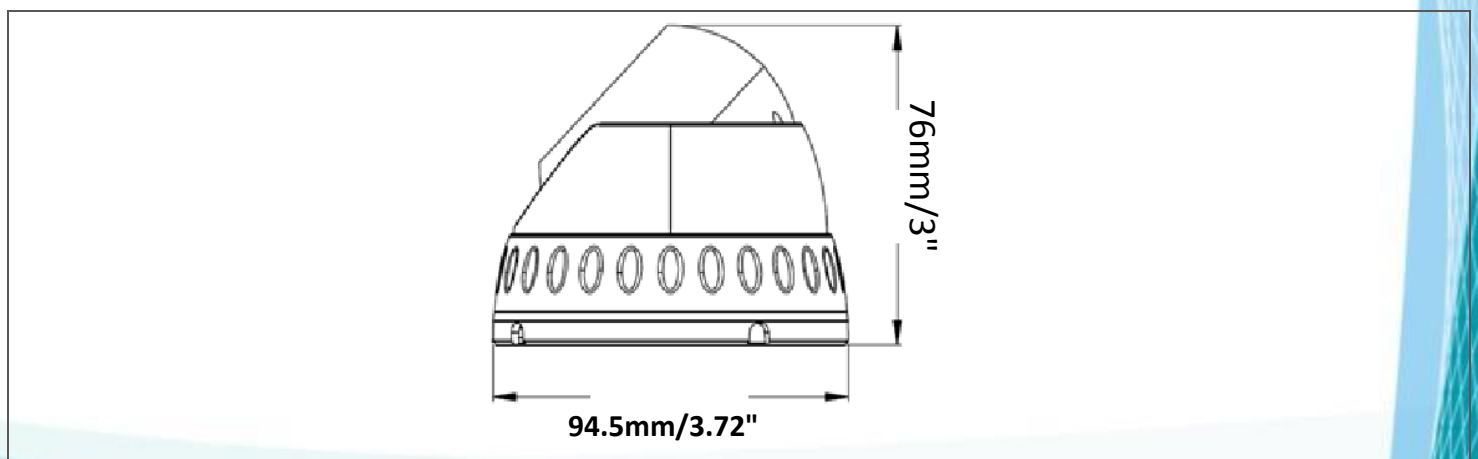

## Optional Accessories

### BA-E310



Color: White  
 Size (Φ x H): 101 x 52mm / 3.98" x 2"  
 Weight: 540g / 1.2lb  
 Material: Metal

### BA-E173

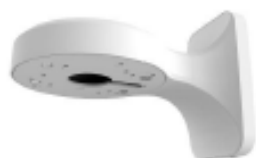

Color: White  
 Size (W x D x H): 173 x 111 x 114 mm / 6.81" x 4.37" x 4.49"  
 Weight: 700g / 1.5lb  
 Material: Metal: Metal

## Specifications

Model No.	EBA1540		
Pickup Device	5MP Sony STARVIS CMOS sensor	Video Format	AHD / TVI / CVI
System Format	NTSC / PAL (switchable via OSD)	S/N Ratio	≥50dB
Effective Pixels	2592 (H) x 1944 (V)	OSD Languages	ENG / CHN / CHN(S) / JPN / KOR / POR / ESPAÑOL
Scanning System	Progressive Scan	DNR	Off / Middle / High / Low
Sensitivity	0 Lux with IR On	T-WDR	96dB
Electronic Shutter	1/25s~1/50,000s , 1/30s~1/60,000s	Sens-up	Off / x2 / x4 / x8 / x16 / x32
Gamma Correction	0.45 / 0.55 / 0.65 / 0.75	Mirror / Flip	Off / On
Lens Type	3.6mm fixed lens with ICR, F1.6	Motion Detection	Supported
FOV (D x H x V)	104.5° x 87.6° x 46.4°	Privacy Mask	Supported
BLC	Off / BLC / HLC / WDR	Environmental	IP66 Weather Resistant
AGC	Auto	Power Source	12VDC, 550mA
White Balance	Auto / Manual	Max. Power Consumption	6.6W
Sync. Mode	Internal	Operating	-10°C ~ 50°C / 14°F ~ 122°F
Day / Night	Supported	Humidity	Less than 95%
UTC Function	Supported	Dimensions (Φ x H)	94.5 x 76mm / 3.72" x 3"
IR LEDS	18 Units	Weight	450g / 1lb
IR Distance	Up to 20m / 66ft. (Depends on scene IR reflectivity)	Certificates	CE, FCC, RoHS

### Find Out More At:

**EverFocus Taiwan HQ:**  
 TEL: +886 2 2662 2338  
[www.everfocus.com.tw](http://www.everfocus.com.tw)  
[marketing@everfocus.com.tw](mailto:marketing@everfocus.com.tw)

**EverFocus USA - California:**  
 TEL: +1 626 844 8888  
[www.everfocus.com](http://www.everfocus.com)  
[sales@everfocus.com](mailto:sales@everfocus.com)

**International Branch Offices:**  
 China, Japan

