



DW-VP122T8P
 DW-VP123T8P
 DW-VP124T8P
 DW-VP126T8P
 DW-VP128T8P
 DW-VP1212T8P



Dimensions (unit : mm [inch])

5 Year Limited Warranty

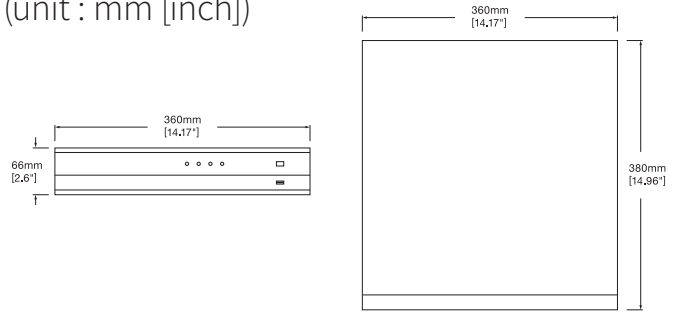

Summary

The VMAX IP Plus™ is an easy to use and hassle-free network recording system (NVR). This new NVR supports all ONVIF® devices via network connection and a resident PoE switch, making the VMAX IP Plus a dynamic solution that can be paired with any conformant camera. With automated camera detection and configuration, the VMAX IP Plus NVR revolutionizes the set up and installation process, allowing you to go from power up to monitoring in less than three minutes! This NVR uses our familiar VMAX user interface for a smooth transition from analog to the world of IP and megapixel. The VMAX IP Plus NVR is available in 9, 12, and 16 channel configurations and up to 12TB internal storage. The VMAX IP Plus NVR is backed by Digital Watchdog's unbeatable 5 year limited warranty.

Features

- Simple and Easy to Navigate VMAX GUI for the most User-Friendly Solution on the Market
- Complete Installation, Setup and Camera Configuration in under Three Minutes!
- Control any ONVIF Camera's Setup and Features Remotely
- Pathfinder™ Auto Port Forwarding
- Monitor and Record up to 12 2.1MP (1080P) Cameras (8-Channels PoE Plus 4 Bonus Channels)
- Local Power for up to 8 IP Cameras via Resident PoE Switch
- Central Management Software
- Mobile Application for iPhone, iPad, iPod, Android Smart Phones and Tablets
- Automatic Device Discovery
- Dual Stream Recording
- Easy Drag and Drop Camera Management
- Instant Backup During Playback
- Full HD (1080P) Output for Local Live & Playback Display
- Complete System Analysis with Real-Time System, Network and PoE Status Monitoring

Specifications



| | | |
|-------------------------------------|---|---|
| Operating System | | Embedded Linux |
| System | Channel | 12 channel |
| | No. of PoE | 8 Ch |
| | Communication Protocol | ONVIF® |
| | PoE Type | 100Mbps, 802.3af |
| Display | Speed | 360fps |
| | Screen Mode | 1, 4, 9 & 12 |
| | Max. HDD Bay | 2 x SATA HDD |
| Video-In | IP Camera (Max. 2 Megapixel) | |
| Video-Out | Monitor | HDMI and VGA |
| | Resolution | HDMI: 800x600, 1024x768, 1280x1024, 1920x1080 (Selectable) |
| Recording Speed | CIF | 360fps |
| | D1 | 360fps |
| | 720P | 360fps |
| | 1080P | 360fps |
| Recording Resolution | Dual Stream | |
| Recording Modes | Continuous, C+M, C+S, Scheduled, Sensor & Motion Detection Recording | |
| | Pre Alarm Recording, Emergency Recording, Quick Backup | |
| Playback & Search | Speed | x1, x2, x4, x8, x16, x32 |
| | Function | Intelli-Search by Time Bar, Calendar (Date & Time) and Event Search |
| Audio Output | 1 Ch | |
| Alarm Input / Relay Output | 4 Ch / 1 Ch | |
| PTZ Control | RS-485, ONVIF | |
| Transaction Verification | TCP and USB-Serial Interface | |
| LAN | 1xGigabit Ethernet (RJ45) – Fixed IP, DHCP & DDNS | |
| Remote Software | Pivot Pro, Web Client, Mobile Client for Android & iOS Smart Phones and Tablets | |
| Backup Device | Local Backup by USB, Network Backup by CMS | |
| System Recovery after Power Failure | Auto-Reboot and Journaling File System | |
| Other Function | Firmware Upgrade | FTP, USB |
| | Back Up | USB |
| | Special Features | Local PoE Switch |
| | Health check | Real-Time System, Network and PoE Status Monitoring |
| System Operation | IR Remote Controller, USB Mouse, PTZ Control by Keyboard (Option) | |
| Power Requirements | 48V DC | |
| Power Consumption | 158.4W Total Power Budget, 3.3A, 15.4W per PoE Port | |
| Operating Temperature and Humidity | 5~40 °C / 20~90% RH | |
| Dimension (WxDxH) | 360 x 380 x 66 mm (14.17 x 14.96 x 2.6 inch) | |
| Certification | CE & FCC, RoHS | |

*NOTE: Specifications subject to change without notice.

Accessories (Optional)

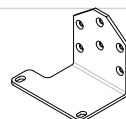

DW-VR19E
19" Rack Mount Ears

